

BENRUN

PRODUCT BROCHURE 产品手册



杭州本润制冷设备有限公司
Hangzhou Benrun Refrigeration Equipment Co.,LTD





About us

Hangzhou Benrun Refrigeration Equipment Co., Ltd. was established in 2003. It is one of the earliest professional manufacturers in China to produce fin condensers, evaporators, cooling coils, and air-cooled units.

The factory is located in Changkou Town, Fuyang District, Hangzhou City, Zhejiang Province. The factory building area is more than 20,000 square meters. It has eight advanced production line equipment, an independent research and development team and mature and stable production technology. The annual production capacity reaches one million sets. It has passed ISO9001 quality system certification, European CE certification and American UL certification to ensure stable and reliable product quality.

The fin-type heat exchanger products produced are widely used in household air conditioners, vehicle air conditioners, mobile air conditioners, central air conditioners, dehumidifiers, air source heat pumps, surface coolers, refrigeration and refrigeration equipment, air conditioners for communication environment control systems, and air-cooled units, chillers, marine and industrial cooling systems and other industries.

Hangzhou Benrun Refrigeration Equipment Co., Ltd. adheres to the corporate philosophy of "customer first, craftsmanship and quality". With its strong strength and high-quality services, it has won the trust and support of domestic and foreign customers, established good cooperative relationships, and strives to become a high-quality brand in the industry.

Transportation



High-speed train



Airplane



Ship



Truck



Cold chain truck



Metro

Used in Medial, peninsula and clean space purification units



Food display cabinet



Peninsula unit



Medical unit

Air conditioner



Drying equipment



Dehumidifier



Standing cabinet air conditioner



air-conditioner hanging machine



Central air conditioning



Precision air conditioner

Pipe Bending

Fin Punching



Fin Crossing

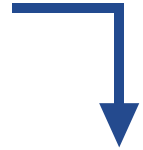

Pipe Expanding

Pipe Expanding: Fully automatic pipe expanding machine and manual tube expansion can meet customers' product size needs to the greatest extent.



Automatic Welding



Degreasing



Automatic Welding: It has the most advanced automatic welding equipment and meticulous manual welding technology; it constantly develops new welding technologies so that the products can adapt to various usage environments and the quality is more guaranteed.

Packing

Leak Detection



Helium leak detection equipment

1. The leak detection sensitivity is high, the minimum detectable leak rate is: $1 \times 10^{-8} \text{ Pa} \cdot \text{m}^3 \cdot \text{S}^{-1}$, and it can detect the overall comprehensive leak rate of the workpiece;
2. Specially designed sealing fixtures to achieve sealing of different types of workpieces;
3. It can eliminate interference from human factors and avoid false detections and missed detections;
4. The helium recovery rate is above 98%, reducing helium consumption and cost;
5. Determines tiny leaks with 100 to 1,000 times more accuracy than the water detection method or air pressure difference method.

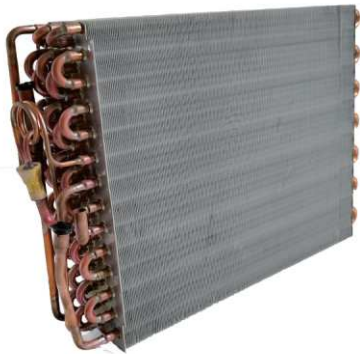

Copper tube aluminum fin heat exchanger



Copper tube copper fin heat exchanger



All stainless steel heat exchanger



Water refrigerant heat exchanger



Air refrigerant heat exchanger



Refrigerant heat exchanger



Flat-plate heat exchanger



Bending heat exchanger



Special-shaped heat exchanger

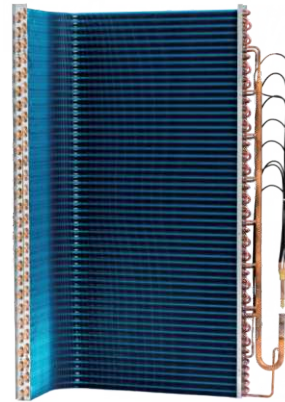

Ordinary hydrophilic heat exchanger

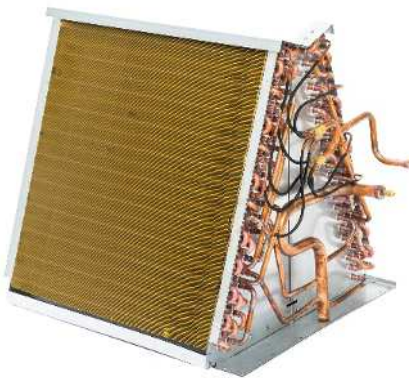

Medium corrosion resistant heat exchanger



High corrosion resistant heat exchanger



Aluminum foil

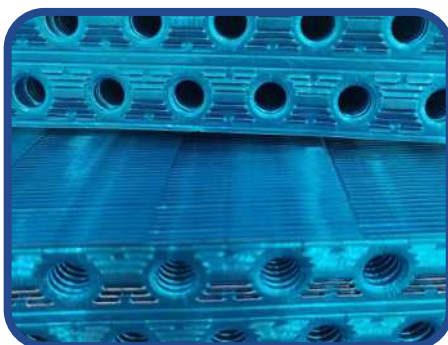

Hydrophilic foil



Copper foil



Epoxy gold foil

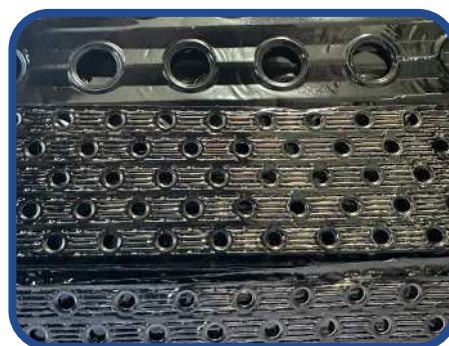

Nano epoxy anti-corrosion black foil

Copper tube



Stainless steel tube

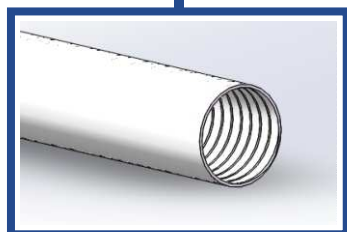

Grooved copper tube

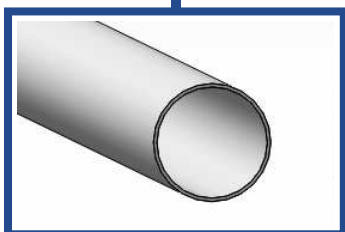

Smooth copper tube

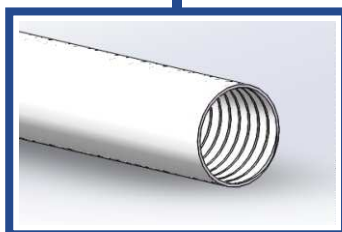

Smooth stainless steel tube

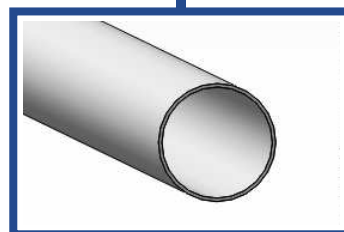

Grooved stainless steel tube

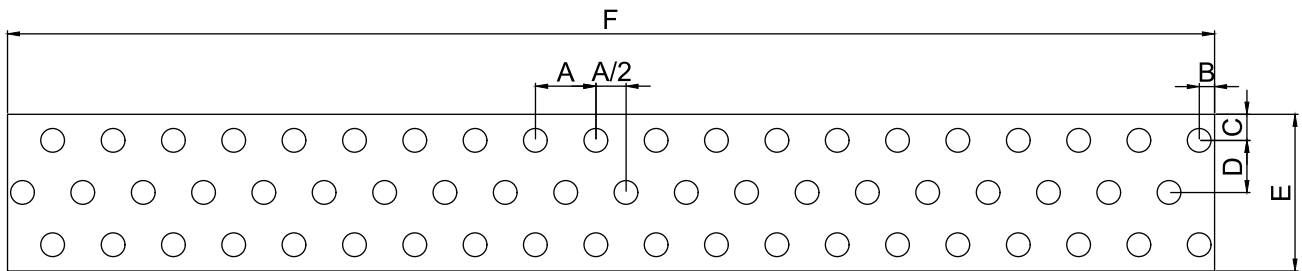

Pattern List

Unit: mm

No.	Tube dia.	Holes space(A)	Rows space (D)	Fin space	Fin type
1	φ 5	19.5	11.6	1.3-2.5	Flat/Louvered
2		21	18.2	1.2-4.23	Flat
3	φ 7	25	21.65	1.3-2.5	Corrugated/Flat/Louvered
4		21	18.19		Corrugated/Flat/Louvered
5		21	13.37		Corrugated/Flat/Louvered
6		20.5	12.7		Corrugated/Flat/Louvered
7		19.05	16.5		Corrugated/Flat/Louvered
8		21	13	1.2-2.5	Flat/Louvered
9		17.60	13.2	1.2-2.0	Flat/Louvered
10	φ 7.94	22	19.05	1.3-2.5	Corrugated/Flat/Louvered
11		25.4	19.05	1.1-2.5	Corrugated/Flat/Louvered
12		25.4	15.88	1.5-3.2	Corrugated/Louvered
13	φ 9.52	25	21.65	1.1-7	Corrugated/Flat/Louvered
14		25.4	22	1.1-2.2	Corrugated/Flat/Louvered
15		19.05	16.5	1.1-2.5	Corrugated/Flat/Louvered
16		25.4	25.4	3.0-8.47	Flat
17		25	19	1.2-3.3	Flat
18		25	12.5	1.5-3.0	Flat
19		25.4	19.05	1.5-4.2	Corrugated/Louvered
20		20.32	17.6	1.5-3.2	Flat/Louvered
21		25.4	15.88	1.6-4.5	Corrugated/Flat
22	φ 12.7	31.75	27.5	1.8-4	Flat/Louvered
23	φ 15.88	38.1	33	2-7	Corrugated/Flat/Louvered



Detection Method

- **PRINCIPLE ZERO DEFECT**

Strict system requirement and practical operation method to material incoming, processing control, factory inspection, and transportation.

- **MATERIAL INCOMING**

Select the large manufacturing enterprise suppliers from domestic and international. and have specially-assigned person for material detecting and tracking

- **PROCESSING CONTROL**

Take three-type inspection system for each procedure: self-inspection, each cross-examination, and the specialist

- **FACTORY INSPECTION**

Assure each product to be inspected in all processes And attach test report following customer's request.

- **PACKING METHOD**

Follow customers' request and accord with environmental protection and safety.

- **TRANSPORTATION**

Follow customers' request of negotiable shipping method and delivery date.

Design Ability

We have senior design engineers, can respond to customers' request in drawing within 24 hours and track for confirmation.

Manufacturing/OEM Ability

We have full sets of equipments and workmanship for manufacturing ability: over billions per year. daily output can reach 1000sets.

Service

Feed back within 8 hours or all your call, fax and mail, and give exact response within 24 hours.

合 作 · 共 赢 · 创 新 · 发 展

Cooperation · Win-win · Innovation · Development

Hangzhou Benrun Refrigeration Equipment Co.,LTD

Tel: 0086-571-86616288 Email: admin@benrun.net Web: <http://www.benruncool.com>
NO.18 Mashan Road,Changkou Town,Fuyang District,Hangzhou City,Zhejiang Province,China