

SEASON  
GROUP

SG / Enabling  
Innovators

# Let's get acquainted.

We're your next design and manufacturing partner.

*embedded world 2025*

A group of smiling African children, with one child in the foreground holding a small, worn globe. The globe is blue and white, with some brown patches, and is held in front of the child's face. The background is blurred, showing other children and greenery.

We believe in making technology accessible  
and shaping the future.

This is our why.

SEASON  
GROUP

SG / Enabling  
Innovators



A group of young children, likely in a classroom, are seated at a wooden desk. The child in the foreground, a young girl with braided hair, is looking directly at the camera with a slight smile. She is wearing a tan jacket over a pink shirt and is holding a piece of white chalk over a small, dark slate. Other children are visible in the background, also wearing similar tan jackets, and they appear to be writing on their own slates. The background is slightly blurred, showing a patterned wall.

In just 6 years, SG provided a million families  
in Africa the opportunity to work towards  
their goals and escape poverty.

SEASON  
GROUP

SG / Enabling  
Innovators



A SERIES OF STRATEGICALLY ALIGNED EVENTS

# How it started

- Customer is a fintech company that provided electricity to homes in Africa using a pay-as-you-go business model
- The customer approached us in 2013, saying:

*“ If we don’t design and manufacture a product within a year, **we’re done.**”*



A SERIES OF STRATEGICALLY ALIGNED EVENTS

# The SG set-up

- Manufacturing facility set up at unconventional location at Havant, UK for small volume production, while Dongguan, China facility provides mass production support
- Design offices established at both the UK and China to offer value-added services

**Proof-of-concept to production in 9 months:**

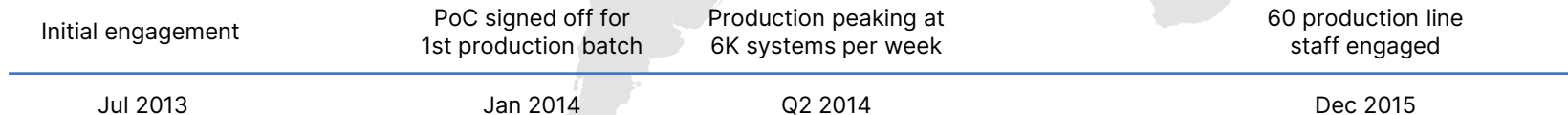

Havant, UK:  
○ Small volume production  
○ Value-added design

Dongguan, China  
○ Mass production

Africa

SEASON  
GROUP

SG / Enabling  
Innovators

A SERIES OF STRATEGICALLY ALIGNED EVENTS

# Laying the foundation

- The customer is now serving 5 million end users across Africa.
- SG has supported them in **making technology accessible** so it can be leveraged to help improve people's quality of life.
- It is under such conditions that people can turn their thoughts towards **shaping a future** that may not have been easily attainable before.





We provide smart connectivity solutions to empower continued efforts in advancing the healthcare industry.

SEASON  
GROUP

SG / Enabling  
Innovators



# Wireless Emergency Call System

- Main Unit

Indoor **BLE-to-LTE** 4G network access point supports eight Panic Buttons.

- BLE Range Extender

Flexibly propagates signals **around corners and through concrete**, powered by Nordic nRF52840.

- BLE Panic Button

Robust wearable ensures **constant and instant one-second connection** with minimal blind spots.

Main Unit



BLE Range Extender



BLE Panic Button





# Continued advancements



	Wireless Emergency Call System <i>New launch</i>	Emergency Call System <i>Legacy product</i>
Responsiveness	<b>Proactive</b> <ul style="list-style-type: none"> <li>Continuous service expansion for <b>predictive elderly care</b>: medical sensors, fall detection, preventive alerts</li> <li>Call back via <b>voice broadcasting</b></li> </ul>	<b>Reactive</b> <ul style="list-style-type: none"> <li>Used as-is</li> <li>Treatment rather than prevention</li> </ul>
Coverage	<ul style="list-style-type: none"> <li>4G LTE and 2G for <b>all network operators</b></li> <li><b>Range extension</b> available</li> </ul>	<ul style="list-style-type: none"> <li>Fixed landline</li> <li>Physical proximity required</li> </ul>
Design	<ul style="list-style-type: none"> <li>IP65, IP66, IP68 waterproof <b>certified</b></li> <li>Plug-and-go installation</li> </ul>	<ul style="list-style-type: none"> <li>Insufficient for prolonged water contact</li> <li>Technical support required</li> </ul>

# Breakthrough for assured safety



- Wireless System (1m above floor)
- BLE Panic Button
- BLE Range Extender

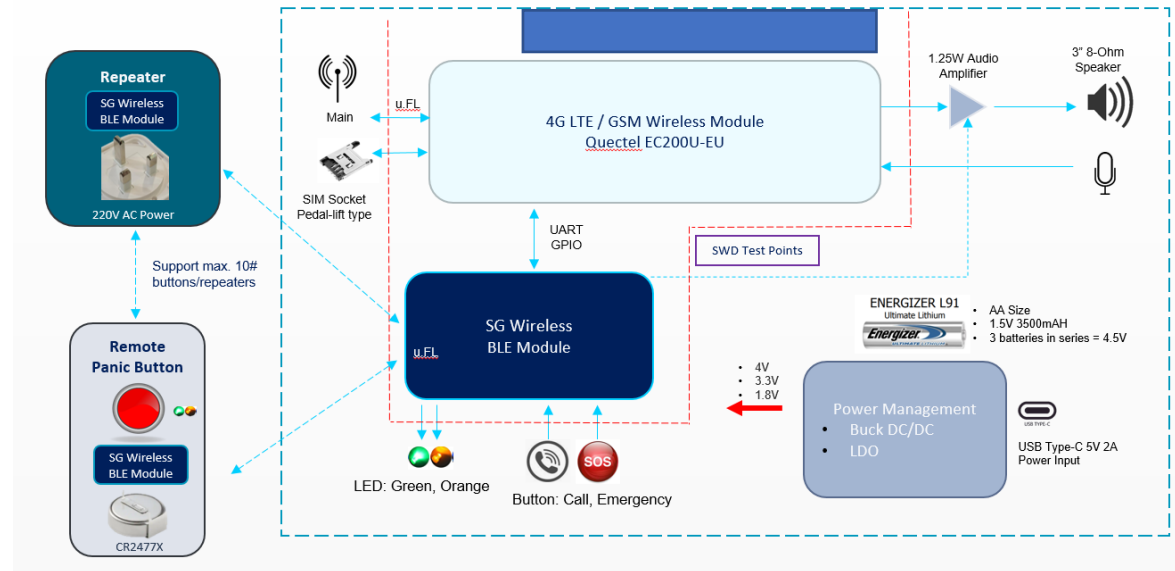

System Block Diagram

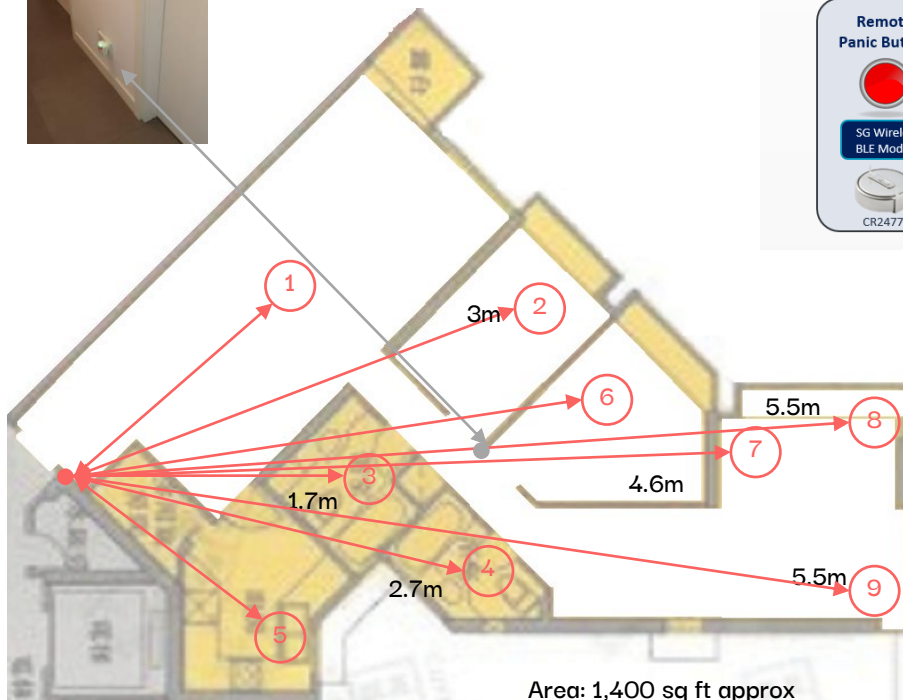

Indoor Range Tested and Proven  
across 1,400 sq ft.



We provide smart connectivity solutions to empower continued efforts in advancing power and utilities.

SEASON  
GROUP

SG / Enabling  
Innovators



# Modularity for flexibility

## Basic Input and Output Modules

- Standardizing AC, DC Power module
- Design enables flexibility in connecting input and output power modules, simplifying wire assembly

Basic Input Module



Basic Output Module



Multi-mount Output Module



## Surge Protection Modules

- Variants for multi-MOV and series mode surge protection
- FCC and EMC-certified

Surge Protection Module  
Multi-MOV



Surge Protection Module  
Series

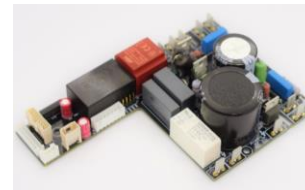

Dual Coil Series Inductor



## Modular Front Panel

- Easily installed by direct mounting on metal chassis
- Enables user-specific interface while maintaining consistency of design language

Front Panel - Version B



Front Panel - Version S



Front Panel - Version P



# Modular design for power distribution

- Pre-built modules simplifies final assembly for easy build-to-order
- 2 product lines with total of 24 SKUs shipped at product launch, using only 6 modular components
- Flexibility for product line expansion

Product Line H

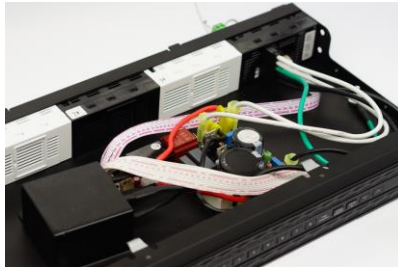

Product Line C



Let's create  
*something great*