

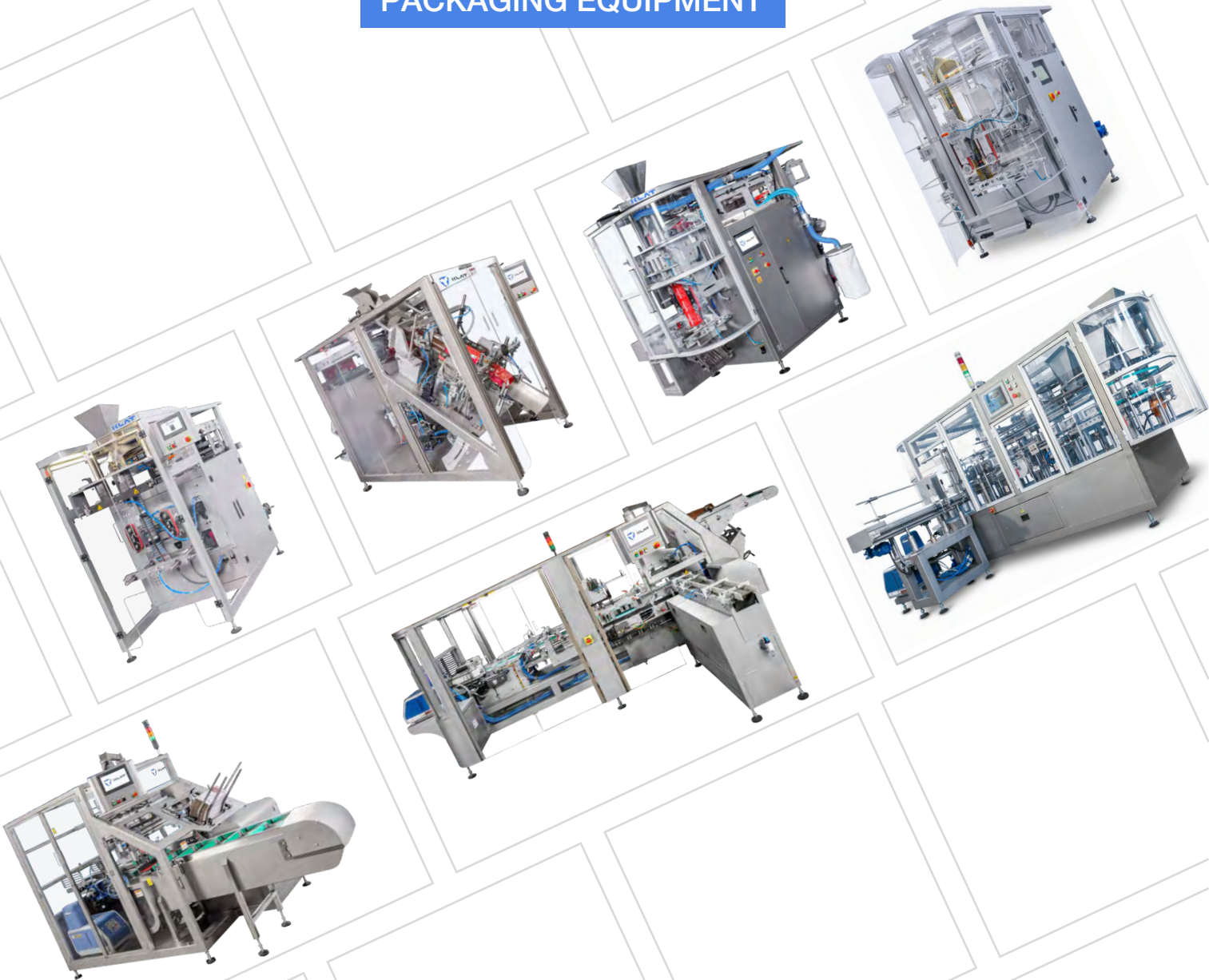

KLAT

PACKAGING EQUIPMENT



www.maxklat.de

About the company

At KLAT, we understand the importance of efficiency and productivity in today's fast-paced manufacturing environment. That's why we have developed machines that are both user-friendly and reliable, allowing our customers to increase their production output while reducing downtime.

KLAT is committed to continuous innovation and improvement, and invests in research and development to stay at the forefront of new technologies and industry trends.

They are dedicated to providing excellent customer service and building long-term relationships with their Partners.

Our team of experts is available to assist our clients with installation, maintenance, and technical support, ensuring that their machines are running at peak performance. We work closely with our clients to understand their unique needs and provide customized solutions to meet their specific requirements.



Competencies

- ▶ Design and development of packaging equipment.
- ▶ Experience in implementing projects for packaging in cardboard boxes of non-standard shapes.
- ▶ Guaranteed perfect packaging appearance.
- ▶ Development and implementation of unique complex projects in various industries.
- ▶ Individual approach to each client.
- ▶ Continuous improvement of packaging technologies to achieve the specific goals of each customer.
- ▶ Optimisation of production due to the simplicity and efficiency of the solutions implemented.
- ▶ Packaging automation for cartoning machines.



Horizontal cartoner KLAT 90-HCI

The advantages of using continuous horizontal cartoners include increased efficiency, stability and flexibility. This is a reliable machine that implements the packaging process due to the modular design of the machine for easy equipping with the necessary types of units and implementation of various tasks of piece and group packaging of the product.

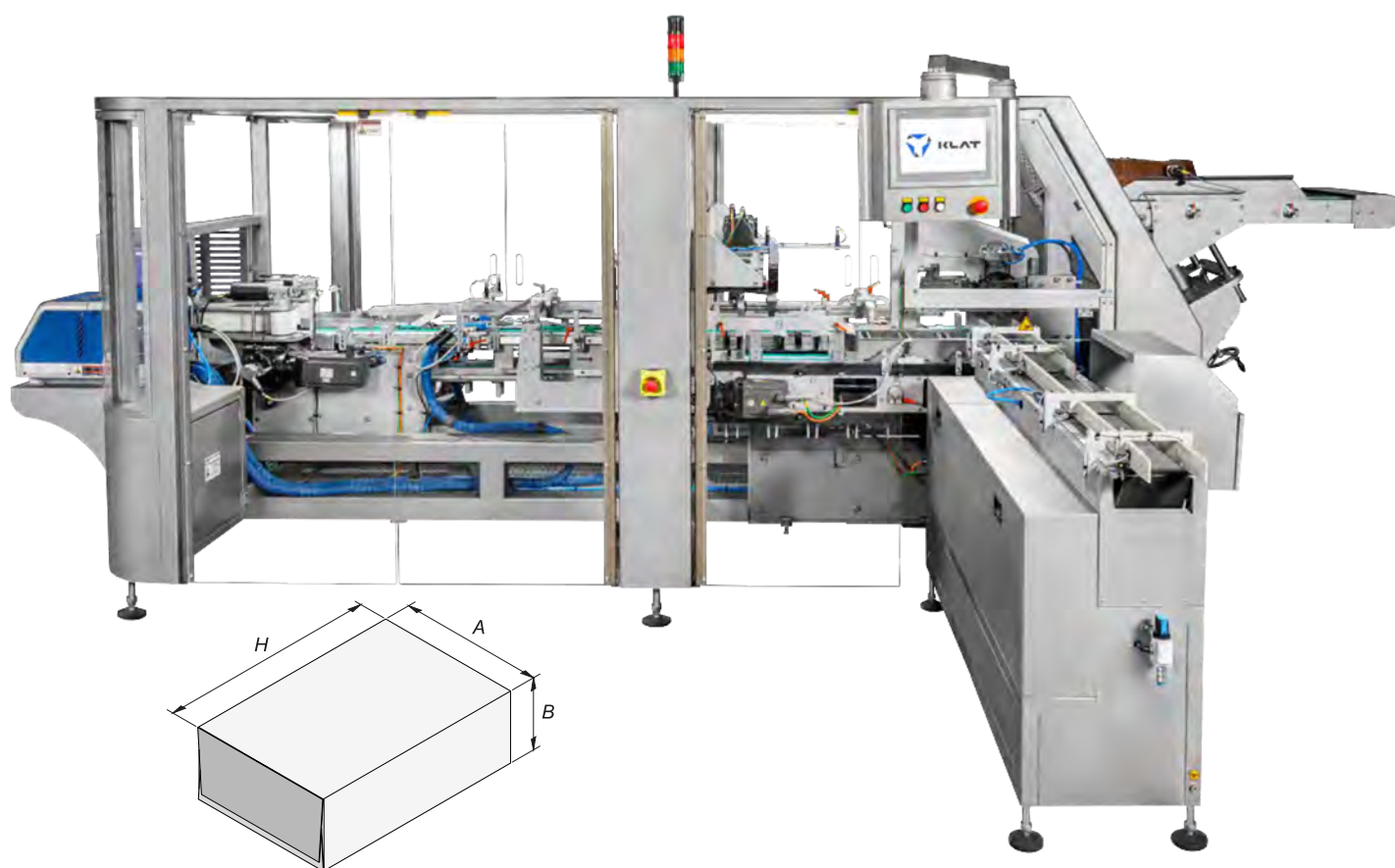

Modification	KLAT-90-HCI A	KLAT-90-HCI B	RLAT-90-HCI C	KLAT-90-HCI D
Capacity, boxes/min., up to	50	70	90	90
Pitch of pack conveyor pushers	15"	12"	9"	6"
Box sizes: <ul style="list-style-type: none"> width A, mm height B, mm depth H, mm 	80...310 20...100 100...350	60...240 20...100 100...300	50...180 20...80 100...350	40...120 15...80 80...250
Maximum number of pusher positions	1	2	4	4
Gluing station	Nordson/Robatech			
Power consumption (without glue station), kW	9			
Operating air pressure, Bar	6			

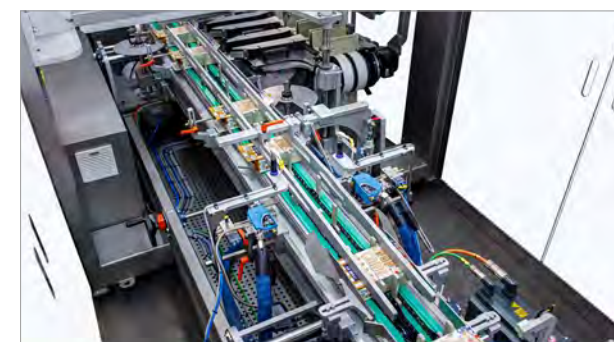

The cartoner is designed for in-line integration with an automatic product feeder:

- From VFFS machines.
- From a flow pack or several flow packs.
- From conveyor system.



The possibility to complete the equipment:

- Collator for collecting the required product groups with the ability to feed the product conveyor to the collating system from the side (perpendicular to the machine) or rear (along the direction of the process flow) of the machine. Synchronised product feeding into moving boxes.
- A conveying system for the automatic process of feeding, collecting and placing the product from the production line into the packaging carton.

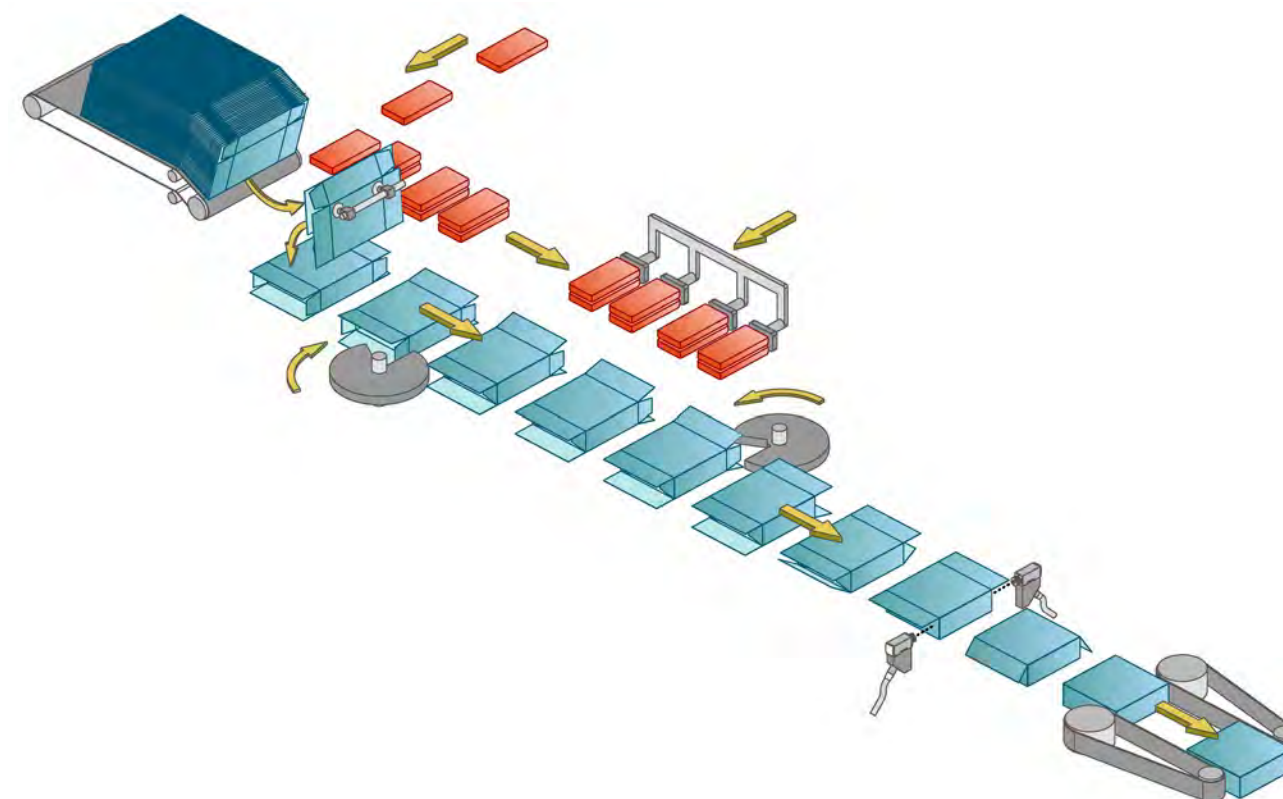

Horizontal intermittent cartoner KLAT-60-HCI

Horizontal intermittent cartoners are designed for businesses that need to pack products into a variety of carton sizes at a slower pace. These machines use an intermittent motion to ensure precise carton positioning and filling, which results in a high-quality pack.



Modification	KLAT-60-HCI-ECO	KLAT-60-HCI A	KLAT-60-HCI B	KLAT-60-HCI C
Capacity, boxes/min., up to	50	40	55	60
Pitch of pack conveyor pushers	10"	12"	10"	6"
Box sizes: <ul style="list-style-type: none"> width A, mm height B, mm depth H, mm 	35...200 20...120 130...400	35...250 20...200 130...400	35...200 20...200 130...400	35...100 20...200 130...400
Maximum number of pusher positions	1	1	1	2
Gluing station	Nordson/Robatech			
Power consumption (without glue station), kW	5			
Operating air pressure, Bar	6			



Allows to pack products in boxes of various shapes:

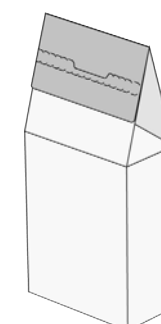
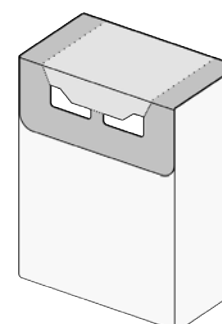
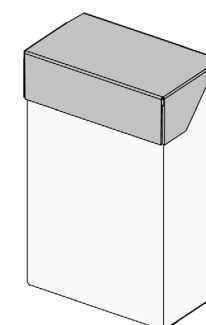
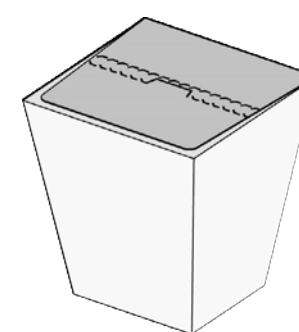

Careful packing of products in a box:

- From vertical machines:
 - from flow-packs;
 - from automatic or manual group stacking system;
 - from a conveyor system.
- The ability to pack both a single product and a group of products in a show box.
- Manual products feeding.

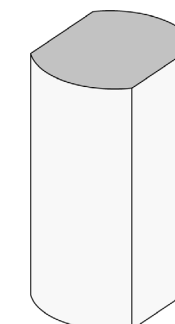

Easy set-up and maintenance:

- Easy conversion from one format to another thanks to the modular design of the replacement parts.
- Improved intuitive user interface:
 - visualisation of the units readiness status during start;
 - flexible control of related equipment from the the cartoner's display;
 - easy recipe setup and management.

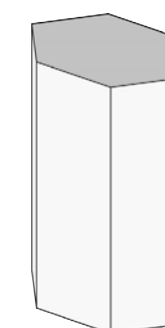

Line for group packaging of products in show-boxes

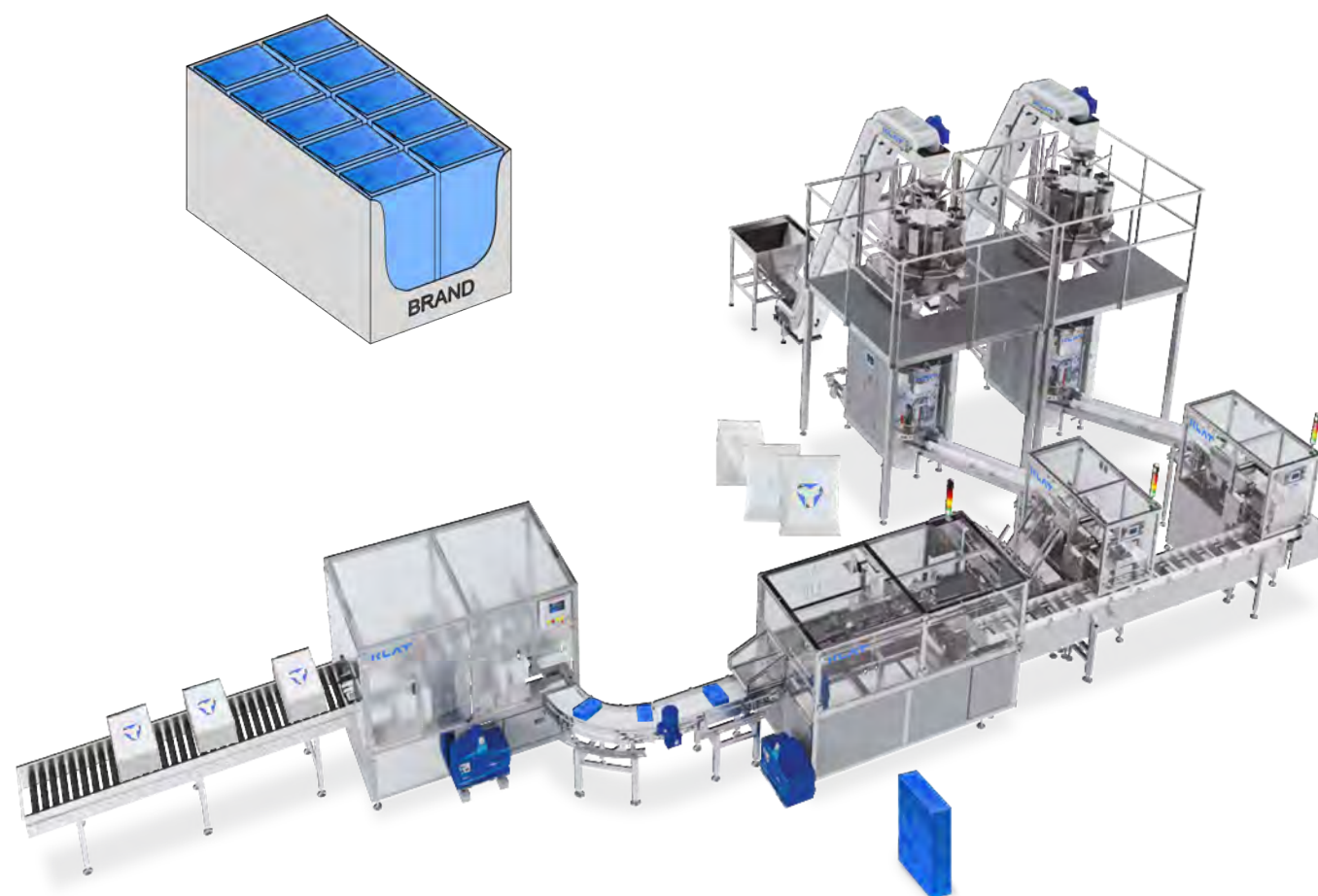

- Ensures a product pick-up rate of up to 100 pmm from each vertical packaging machine.
- Used to synchronise the cartoner with vertical packaging machines or flow packs.
- Fully integrated solution for packing several product pouches in a box.
- Enables the collection, preparation and grouping of different products before packaging.
- Allows you to optimise the box size for the quantity of product with multiple layout options.
- Has a separate control system for more precise and flexible equipment setup.

Product collection and grouping system - collator

- Collects and prepares a group of products on the edge.
- Provides preparation of product bags (alignment, distribution of product).
- Provides product acceptance speed of up to 240 bpm.
- Can serve as a product rejector in case of a shutdown of the equipment following it.
- Allows the cartoner to be synchronised with a vertical packaging machine or sachet machine.
- The servo drive allows for fine-tuning to different product and show box parameters.
- It can handle various types of packaging (Pillow bag, sachet, Doy Pack, flat tins, boxes).

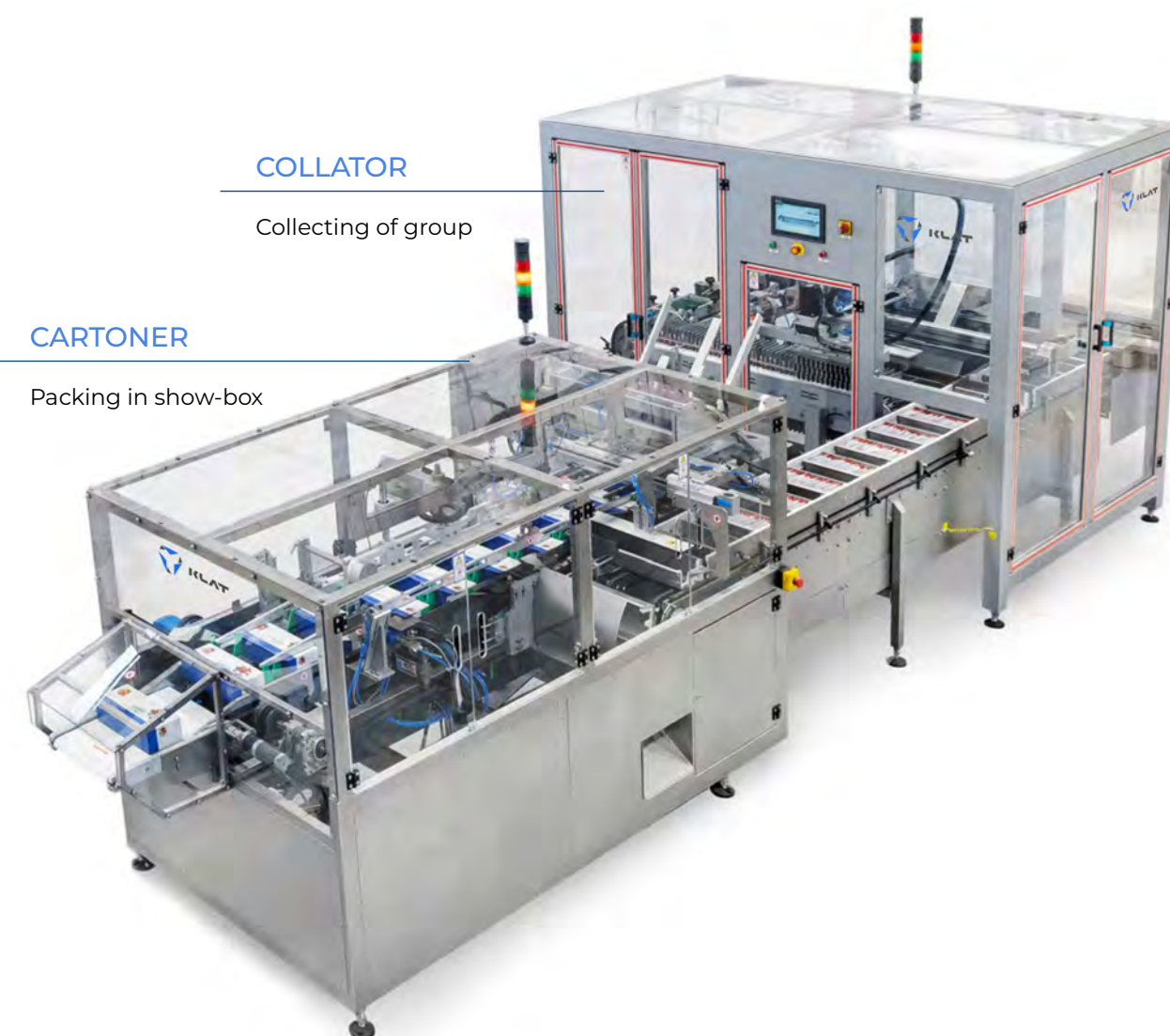

Vertical cartoners KLAT-100-VCC/ KLAT 45 / KLAT-43-VCI



Model	KLAT-100-VCC	KLAT-45	KLAT-43-VCI	
Capacity, boxes/min., up to	100	25	40	
Type of dosing device	Volumetric/ Multihead weigher	Auger filler + multihead weigher	Auger filler + multihead weigher'	
Principle of operation	continuous	intermittent	intermittent	
Gluing station	Nordson/Robatech			
Power consumption (without glue station), kW	3,9		2,5	
Box sizes:			Standard	Gable-Top
· width A, mm	60...180	60...180	60...180	60...180
· height B, mm	30...85	50...90	30...85	50...90
· depth H, mm	130...260	200...300	130...260	110...210

Carton box packaging line with volumetric dosing device and vertical cartoner KLAT-100-VCC



► VOLUMETRIC DOSING DEVICE:

Speed up to : 110
Cups quantity: 8 pcs.



- High dosing accuracy on lightweight products means a deviation of no more than 1% with a constant product density.
- The use of a volumetric dosing device minimises product spillage into the work area.
- Perfect for weighing finely dispersed, complex or bulk products (salt, soda, household chemicals, cereals, oatmeal).

Vertical cartoner KLAT-100-VCC with volumetric dosing device



- The machine is specially adapted for the packaging of salt, soda and other similar products.
- Method of forming the box flaps: - labyrinth (for loose and dusty products).

Continuous vertical cartoner KLAT-100-VCC with multihead weigher



- Method of forming the box flaps: standard (for lumpy and small-piece products).

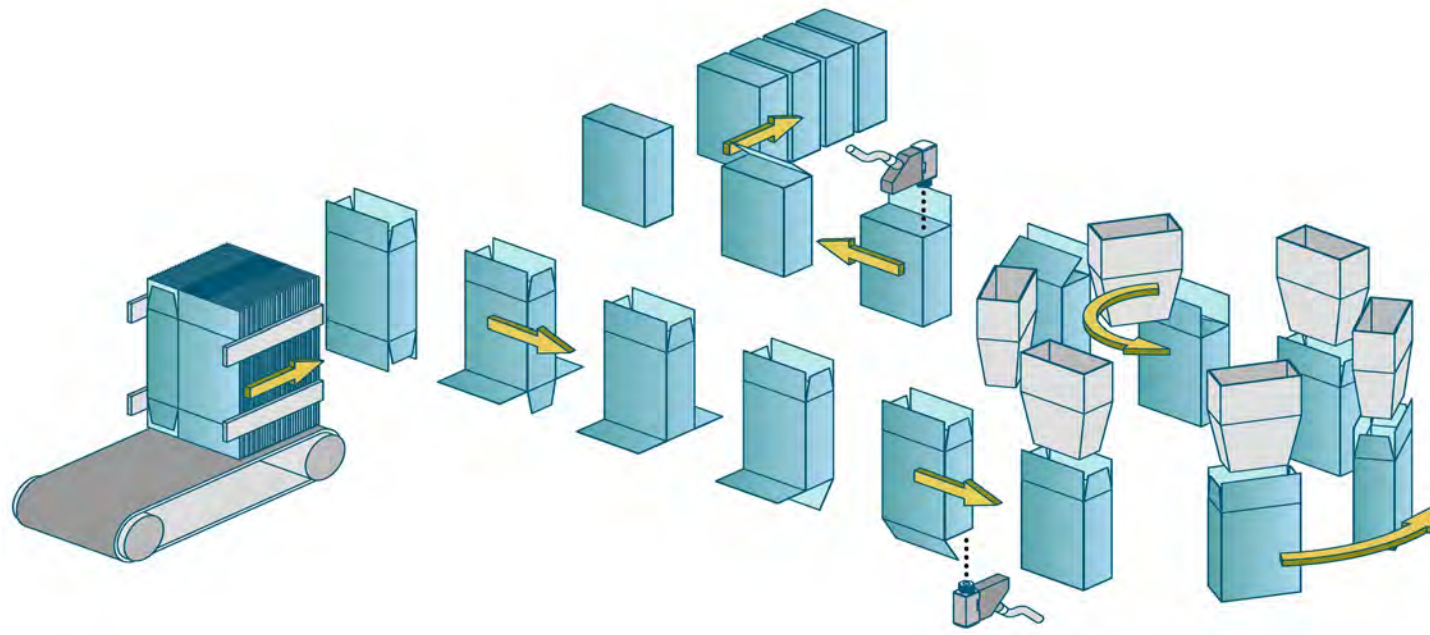

Intermittent vertical cartoner KLAT-43-VCI



- Allows the use of micro-corrugated cardboard boxes.
- Can be equipped with various types of dispensers:
 - combination (multi-head);
 - Auger filler.
- Product can be fed manually.
- Possibility of forming Gable Top boxes and other boxes of non-standard design.

Cartoner KLAT 45 Bag-in-Box



- The machine uses box blanks with a glued paper (laminated) sleeve.
- Allows packaging of dusty (powder) products.
- Tightness.
- Original - cardboard packaging with a paper bag inside.
- High % filling of the pack .



Cartoner Top Load KLAT-70-TL

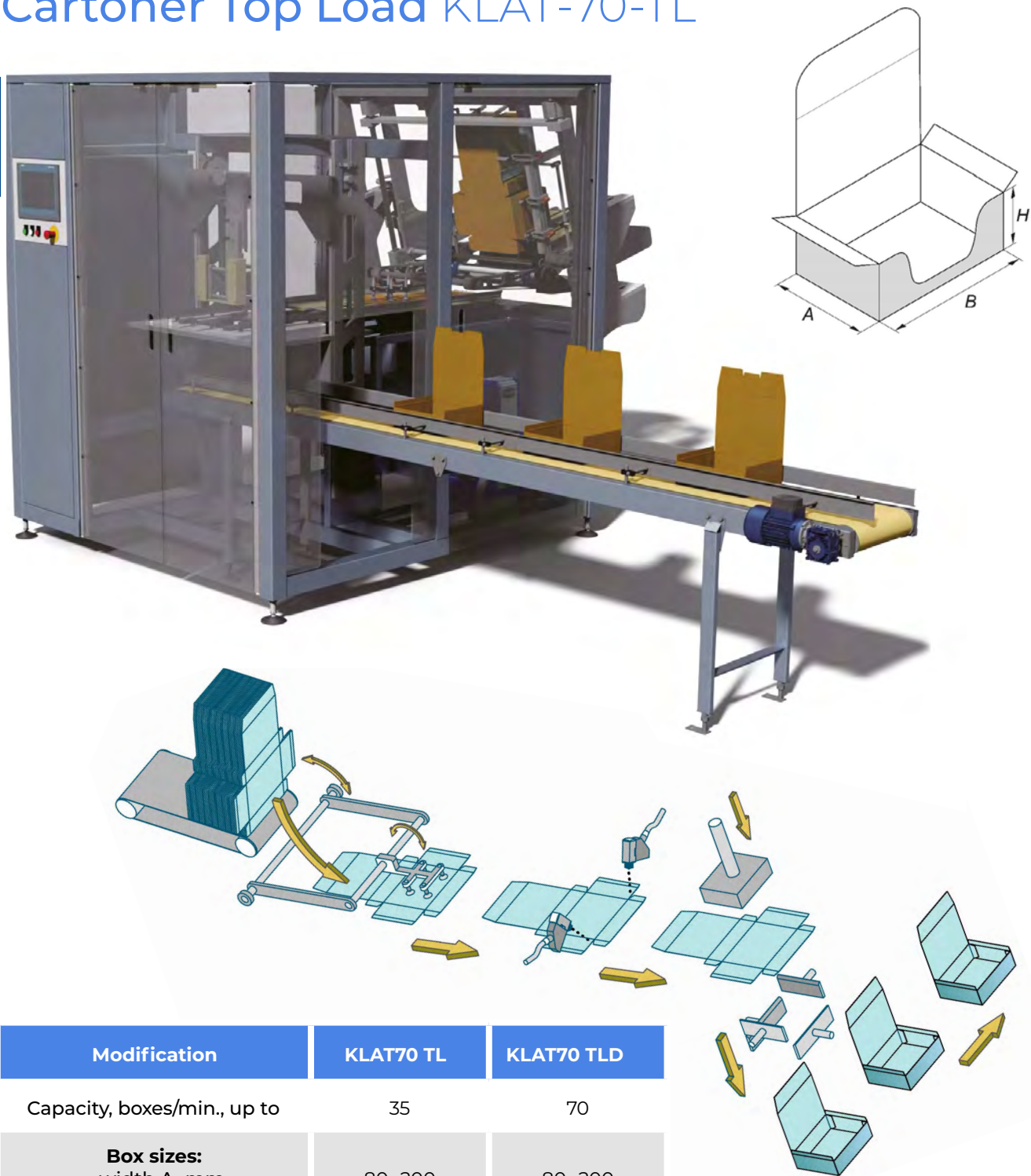

Modification	KLAT70 TL	KLAT70 TLD
Capacity, boxes/min., up to	35	70
Box sizes: <ul style="list-style-type: none">· width A, mm· height B, mm· depth H, mm	80...200 100...270 30...80	80...200 100...270 30...80
Number of mould positions	1	2
Gluing station	Nordson	Nordson
Power consumption (without glue station), kW	4	5
Operating air pressure, Bar	6	6



VFFS packing machines KLAT-20-VF



Main features:

- ▶ KLAT VFFS have a robust and ergonomic design.
- ▶ Additional servo drive in the broaching mechanism ensures high accuracy of stopping the film; the bags are perfectly shaped, with precise dimensions, strong and high-quality seams.
- ▶ Automatic control and adjustment of the film position, the ability to change the parameters directly during the operation of the machine.
- ▶ The ability to integrate reclosers (to preserve product properties) and other options.
- ▶ Convenient and quick changeover when changing bag size convenient and quick changeover when changing the size of the bag.

Model	KLAT-20-VF-CONT	KLAT-20-VF-D	KLAT-20-VF-ST/P/B	KLAT-20-VF-P/ST
Bag type	Pillow / Stand up	Doy Pack/ 3 side seal sachet	Stabilo / Pillow / Stand up	Pillow / Stand up
Capacity, bags/min., up to	120	60	60	100
Bag length, mm	300	300	300	up to 470
Film width, mm	600			
Power consumption, kW	8,3	8,0	8,2	7,5
Special features	The principle of operation is Continuous, maximum speed	Possibility to produce the bag with zip-lock	Wide range of bag shapes	The operating mode is intermittent, reliability and efficiency

High-speed line for packaging products in film bags



KLAT-20-VF-P/B	•	•	•		
KLAT-20-VF-ST/P/B	•	•	•	•	•
KLAT-20-VF-CONT	•				
KLAT-20-VF-D					



VFFS packing machine KLAT 9-VF-P / 9-VF-B / 9-VF-ST / 14-IF-P/B/ST



Model	KLAT-9-VF-P	KLAT-9-VF-B	KLAT-9-VF-ST	KLAT-14-IF-P/B/ST
Bag type	Pillow / Stand up	Pillow / Stand up	Stabilo / Pillow / Stand up	Stabilo / Pillow / Stand up
Capacity, bags/min., up to	50	75	35	35
Film width, mm	600			
Bag length, mm	310			
Power consumption, kW	3	3,7	3,8	3
Special features	Simple and reliable design, efficiency at an affordable price	Increased speed thanks to the use of servo drive	Advanced possibilities, wide range of bag shapes	Designed for fragile products, maximally gentle

VFFS packing machine KLAT-14-IF
with angle adjustment up to 45 degrees



VFFS packing machine KLAT-20-VF-D
for Doy Pack
and Sachet bags



High Dream multihead weighers
and other equipment

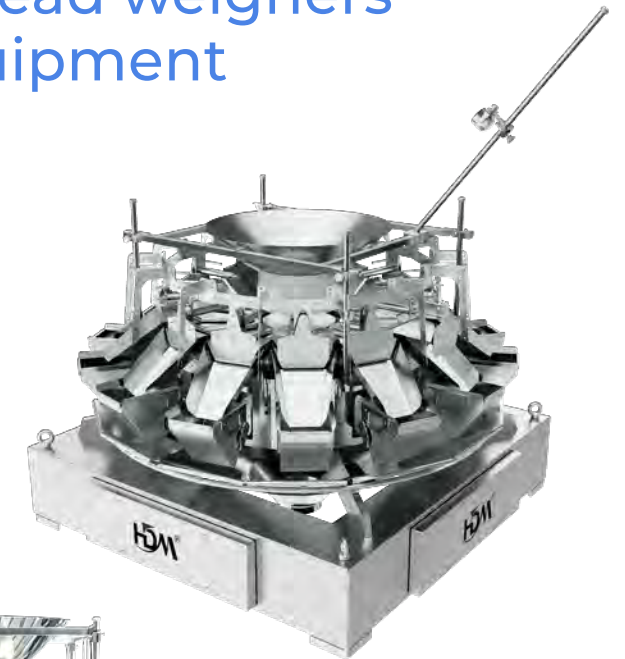



KLAT

**Max Klat
Maschinenteknik GmbH**

73084 Salach, Germany, Spitzenbergstr. 4

Tel.: +49 (0) 7162-9492662

info@maxklat.de

www.maxklat.de