

KINGMATE ELECTRONIC CO., LTD

Company Profile

Board-to-Board Connectors
&
FPC Connectors

Brief Introduction:

www.kingmate.com.tw

- Established : August 1998
- President : Mr. Bison Liao
- Location : Jhubei City, Hsinchu County, Taiwan
- Capital Amount: US\$3,500,000
- Specialize :
 - Board-to-Board Connectors
 - FPC Connectors
 - Customized Interconnecting Solutions
- Certificate :
 - ISO9001
 - ISO14001
 - IATF16949



Operation Locations:

www.kingmate.com.tw



- Headquarters : Hsinchu County, TAIWAN
- Main Functions : Business Development & Sales / Financing
- Employee : 16



- Factory TW : Yingge Dist., New Taipei City, TAIWAN
- Main Functions : Customized Interconnecting solutions & Board-to-Board Connectors
- Employee : 30



- Factory CN : Dongguan, Guangdong, CHINA
- Main Functions : FPC/FFC Connectors
- Employee : 200



Milestone:

- ◆ 1998 --- Kingmate was Established
- ◆ 2000 --- Became agent of SCG for FPC/FFC connector
- ◆ 2003 --- China factory established for Wire Harness / Cable / Connectors
- ◆ 2013 --- Closed China factory and set up Taiwan factory – Wingmate especially for custom-made connectors
- ◆ 2014 --- ISO9001 certificated
- ◆ 2018 --- Developed fine pitch B to B connectors
--- Became Board Member of Guangdong Suncagey
- ◆ 2024 --- IATF16949 certificated

Board-to-Board Connectors:

- Pitch Options : 0.5mm / 0.8mm / 1.0mm / 1.27mm / 2.0mm / 2.54mm
- Soldering Type : Thru-hole / Surface Mount
- Current Rating : 0.5Amps ~ 3 Amps
- Customized : Pin Counts / Mating Height

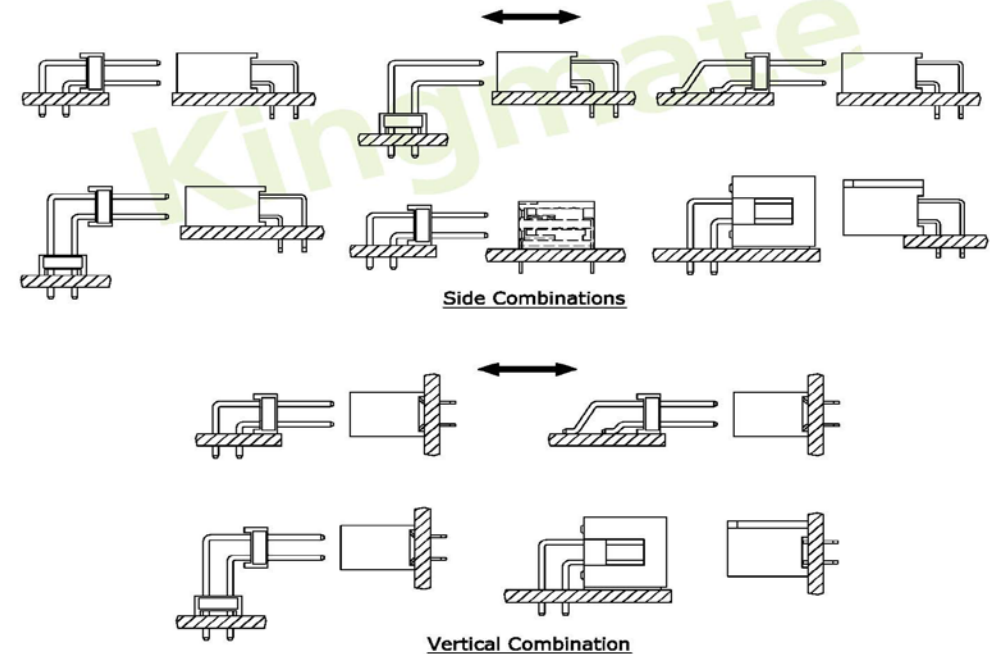
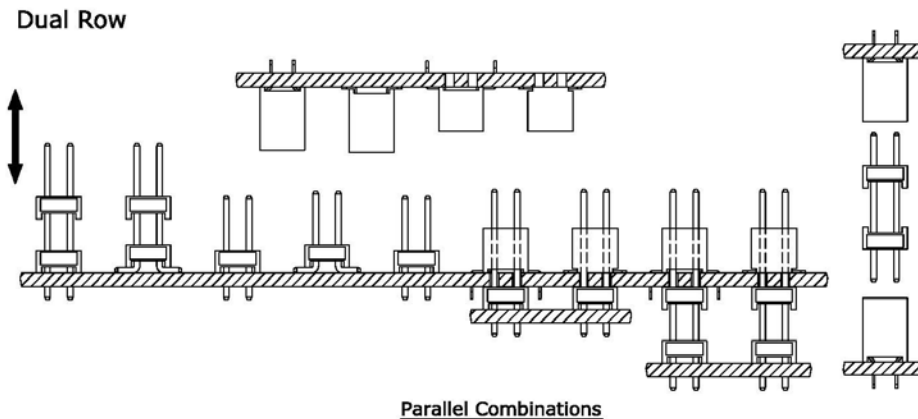











FPC/FFC Connectors:

www.kingmate.com.tw

- Pitch Options : 0.2mm / 0.3mm / 0.5mm / 1.0mm
- Orientation : Right Angle / Vertical
- Soldering : Surface Mount
- Comprehensive Pin Counts Available
- Pin-to-Pin Compatible to Molex, Hirose, Panasonic
- Automation Production, Stable Quality and High Capacity
- Most Popular Solutions:
 - KME0602-xx-DS (0.3mm pitch ultra-low profile)
 - KMG0903-xx-DS (0.5mm pitch)
 - KMG2903-xx-DS (0.5mm pitch with cable locking function)



FPC/FFC Connectors:

Photo	Part No.	Type	Pitch	Height	No. of contacts	Termination style	FPC. Cable (t) mm
	KMD0602-xx-DS	Back-Flip	0.2	0.6	7~51	Right Angle Dual Contact	0.2
	KME06L02-xx-DS KME0602-xx-DS		0.3	0.6	7~51	Right Angle Dual Contact	0.2
	KME09P02-xx-DS		0.3	0.9	13~61	Right Angle Dual Contact	0.2
	KME09H02-xx-DS		0.3	0.9	13~61	Right Angle Dual Contact	0.2
	KMC43NL02-xx-DS KMC43N02-xx-DS		0.3	0.9	9~71	Right Angle Dual Contact	0.2
	KME1002-xx-DS KME1002M-xx-DS KME1002S-xx-DS		0.3	1.0	9~71	Right Angle Dual Contact	0.2
Photo	Part No.	Type	Pitch	Height	No. of contacts	Termination style	FPC. Cable (t) mm
	KME0902-xx-LS KME09M02-xx-LS	Front-Flip	0.3	0.9	9~71	Right Angle Lower Contact	0.2
	KMC2502-xx-LS KMC25M02-xx-LS		0.3	1.0	9~71	Right Angle Lower Contact	0.2
	KMG09N03-xx-DS	LIF	0.5	0.9	4~30	Right Angle Dual Contact	0.2 / 0.3
	KMG0902-xx-DS KMG0903-xx-DS	Back-Flip	0.5	0.9	4~50	Right Angle Dual Contact	0.2 0.3
	KMC1503-xx-LS	Front-Flip	0.5	1	4~50	Right Angle Lower Contact	0.3
	KMC15EH02-xx-LS				4~30		0.2

Customized Interconnecting Solutions:

www.kingmate.com.tw

- Experienced R&D Expertise with Strong Customization Capabilities
- Professional Engineering Support
- Material Research & Development
- Real Case:
 - Panasonic's Electrical Meter Project

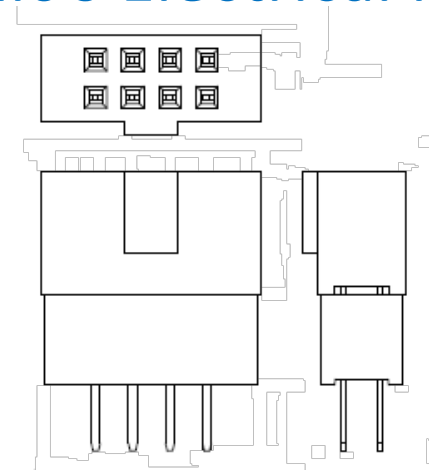

Wire-to-Board Connectors:

Pitch: 0.8mm~1.25mm

KM0802 series (0.8mm)

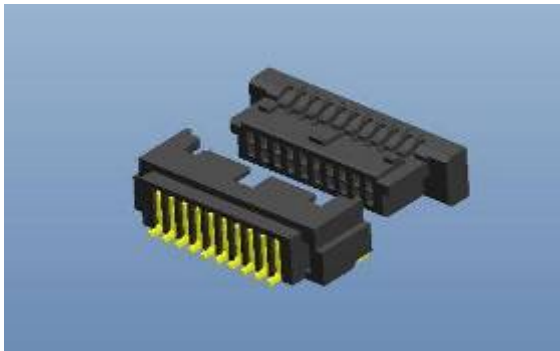

KM1001 series (1.0mm)

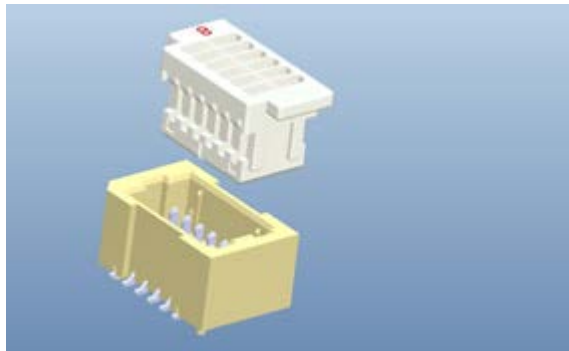

KM1212 series (1.25mm)

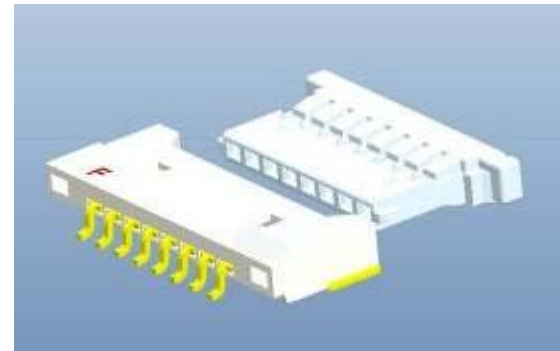

KM1213 series (1.25mm)

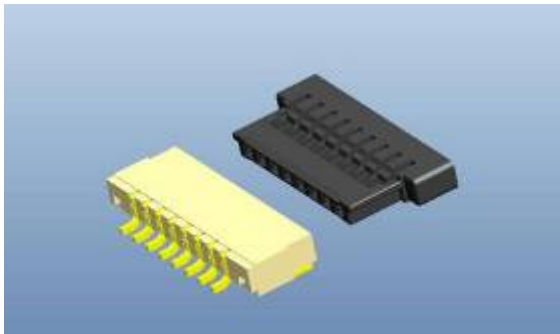

KM1218 series (1.25 mm)

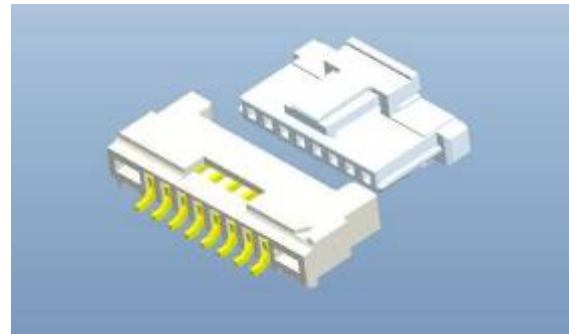

KM1252 series (1.25mm)

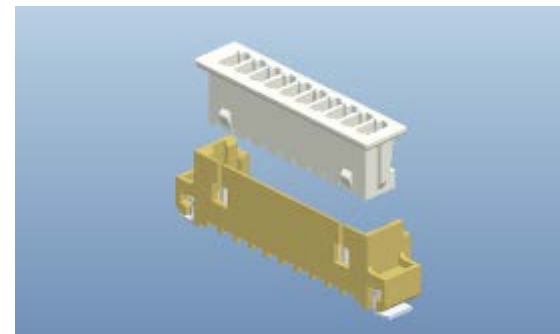

Wire-to-Board Connectors:

Pitch: 1.2mm~2.0mm

KM1202 series (1.2mm)

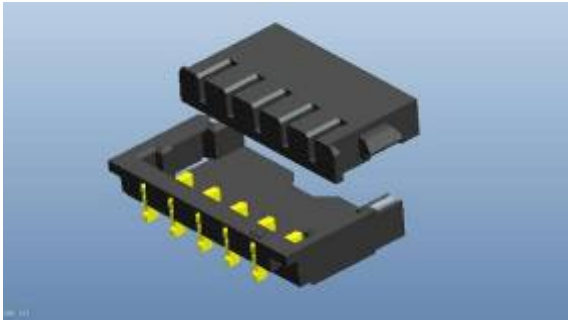

KM1502 series (1.5mm)

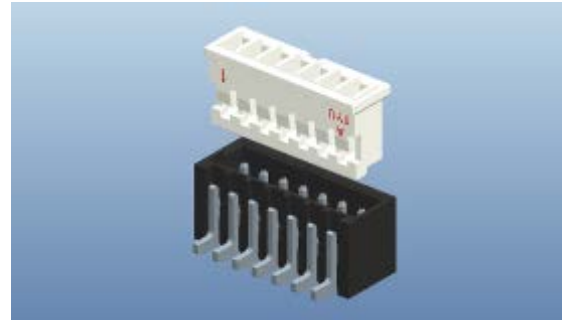

KM1513 series (1.5mm)

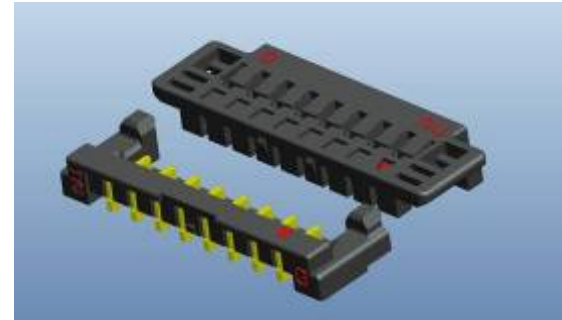

KM2003 series (2.0mm)

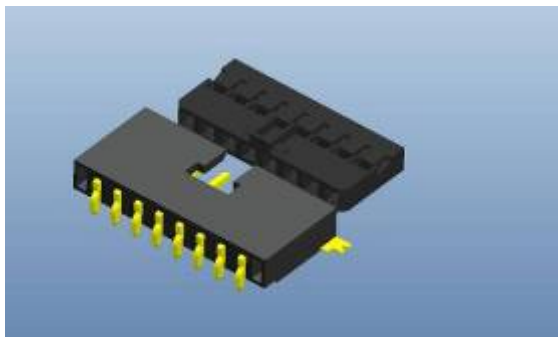

KM2013 series (2.0mm)

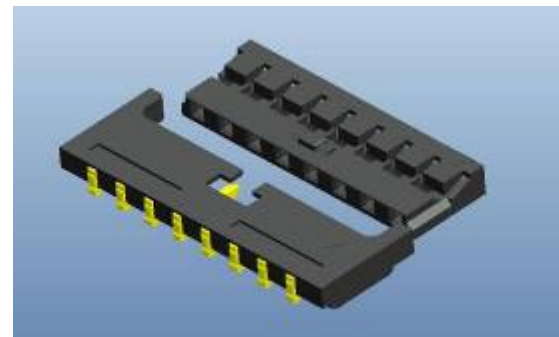

Wire-to-Board Connectors:

Pitch: 1.25mm~3.96mm

KB1262series (1.25mm)

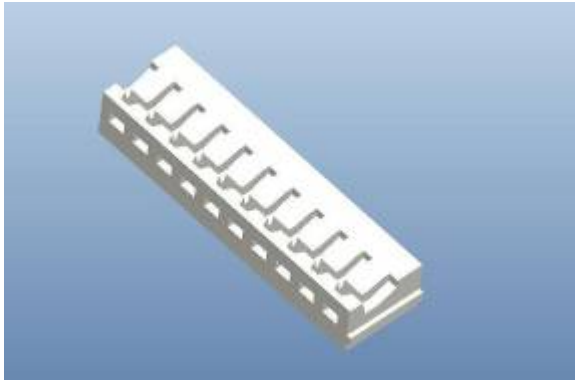

KB1561 series (1.5mm)

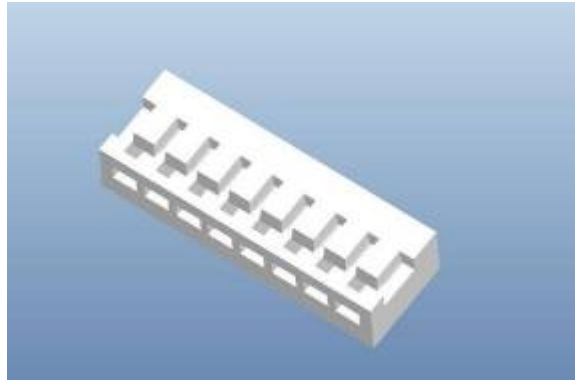

KB2061 series (2.0mm)

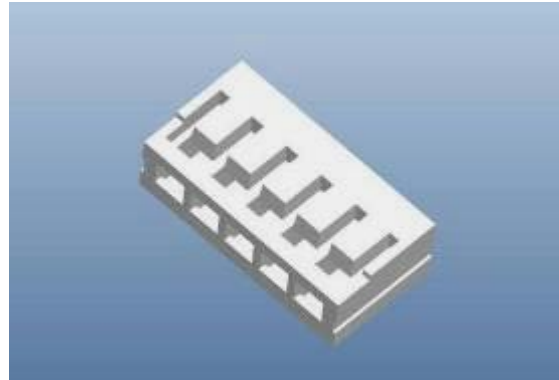

KB3061 series (2.5mm)

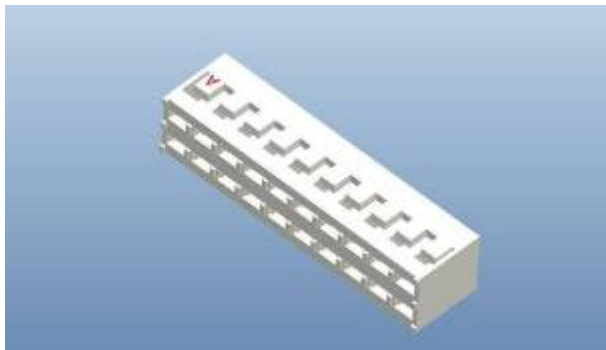

KB6061 series (3.96mm)

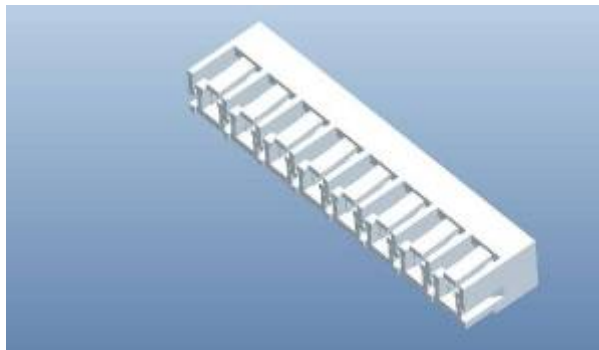

Automation Production Line:

www.kingmate.com.tw

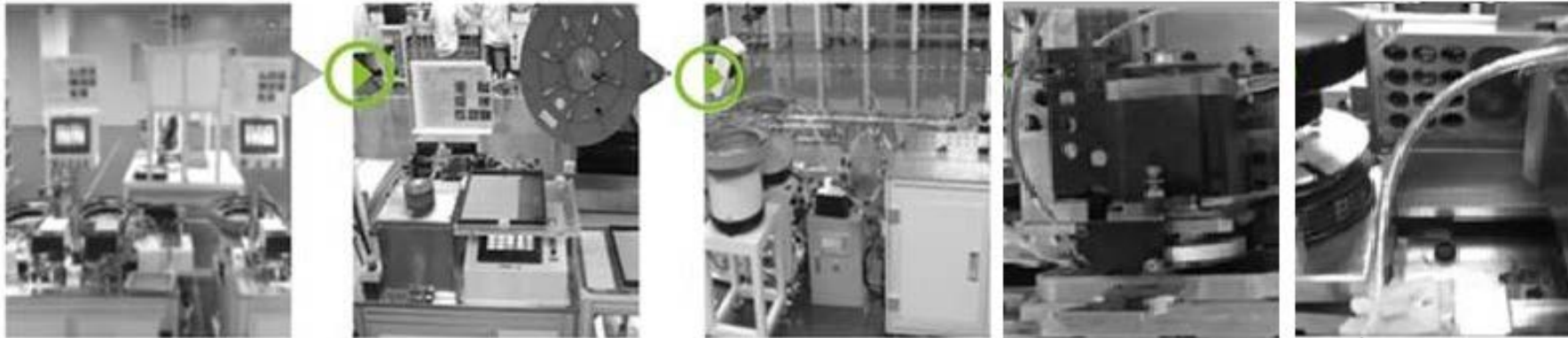

QA Testing Equipment:

www.kingmate.com.tw



Energy Dispersive
X-ray
Fluorescence
Analyzer
能量分散型螢光X射
線分析儀



Retention Force
Tester
自動插拔力機



Withstand
Voltage /
Insulation Tester
耐電壓測試機



IR-Reflow
回焊爐



Peel Force Tester
剝離力測試儀

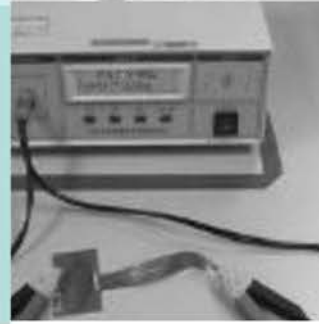

Contact
Resistance Tester
微電阻測試儀



QA Testing Equipment:

www.kingmate.com.tw



Steam Aging
Tester
蒸氣老化測試機



Salt Spray
Tester
鹽水噴霧測試機



Humidity
Chamber
Tester
恆溫恆濕機



High
Temperature
Tester
高溫烤箱



CCD Measuring
CCD 投影機



Microscope
顯微鏡



Business Performance:

www.kingmate.com.tw

Unit : US\$ K Thousand

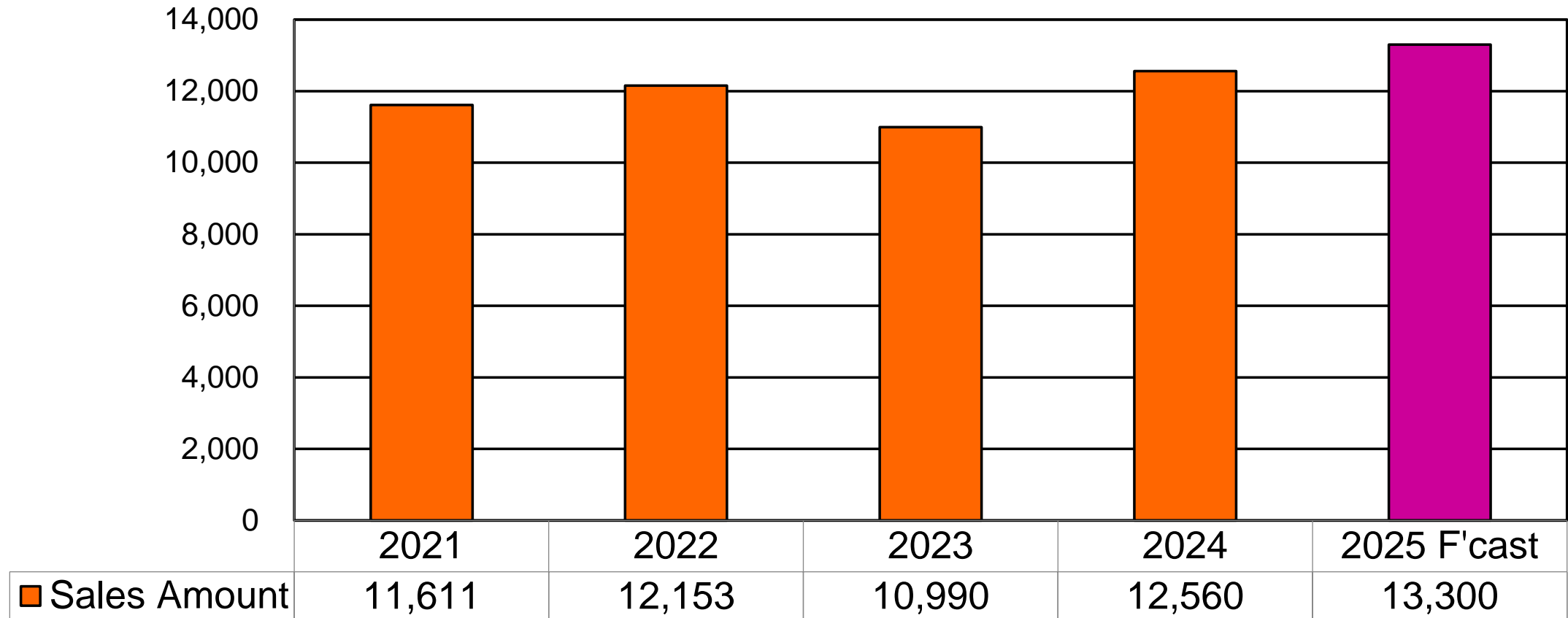

Reference Customers & Applications: www.kingmate.com.tw

- Amazon Ring (Door Bells)
- CISCO (Telecom Devices)
- Foxconn (Touch Panel, Display)
- CANON (Camera Modules)
- Castle Technology (POS, IPC)
- Ubiquiti Inc. (Telecom)
- Panasonic (Electric Meters)
- CREE (LED Connecting)
- ARCELIK (Home Appliances)
- MICRON (Testing Purpose)
- PHISON (Memory Module)



Trust:

- Over 25 Years Experience and Excellent Reputation
- World-Class Quality
- Strong Customization Capabilities
- Design Expertise
- Professional Engineering Support
- Material Research & Development
- Concurrent Product Innovation
- One Stop Solution for Interconnector
- Quick Delivery & Flexible Logistic Support



Kingmate

LINK your PASSION

www.kingmate.com.tw



KINGMATE
CONNECTING TO
YOUR WORLD

Kingmate Electronic Co., Ltd

Tel:886-3-658-7281

Fax:886-3-658-7151

Website: www.kingmate.com.tw