



boondog

Outdoor specialized dog
gear brand "BOONDOG"



boondog

✉ boondog@boondog.co.kr
☎ +82-31-985-3236
📷 @boondog_official
🏠 www.boondog.co.kr



| BOONDOG Technology |



Korea's leading brand

All products of the Boondog are labeled with the national flag of Korea. And all them are genuine products designed and made in Korea. We produce all of our products with pride and responsibility as a Korean brand.



Use of "WOOJIN Plastic", the world's No.1 plastic buckle.

All products of Boondog use strong, sturdy buckle with a streamlined design that fits your dog's body type.

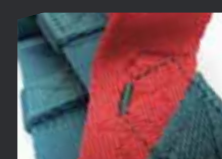

Using German "SERAPIL" yarn.

The Serafil fabric of the 160-year-old German AMANN company, is durable, tough and friction-resistant compared to ordinary yarns. With the most powerful sewing techniques used in fire fighting and mountain equipment, it is safer and stronger.



Soft and sturdy webbing.

All of Boondog's product is made of a webbing of microfiber yarn, which makes it more strong, and soft. It helps prevent dog hair loss and protects the owner's skin against chafing.

Boondog



BOONDOG STORY

Boondog is a Korean brand specializing in dog walking products made with pure domestic technology in Korea.

Walking everyday with our family dog Labrador retriever “MIJA”, made us contemplate from the owner’s perspective of “How convenient would it be if there was a function like this?”, and the designer’s perspective to pursue more unique and stylish design. And these worries led us to start Boondog.

The best way to relieve stress for dogs is to take them for a walk. Letting them smell new things every day can be the best ‘gift’ for them. Boondog will make more joyful and pleasant walking culture for both owner and a dog.

As an outdoor specialized brand, Boondog features an multi-design that goes well with not only natures such as green forests but also decent urban places. On top of that, the colors of Boondog are selected by testing hundreds of color samples with professional colorists to highlight their stylishness through numerous color matching. The design of Boondog seeks comfort in refinement.

This catalog is made with photos taken by “customers who take a walk with their dogs wearing a Boondog”, not a professional model.

Collars



Original Collar 10 colors / 3 sizes

The Boondog original collar makes your dog stand out through stylish color matching. Streamline designed buckles and soft webbing will make your dog feel more comfortable.

Colors of Boondog original collar, which is selected by testing hundreds of color samples with professional colorists to highlight their stylishness through numerous color matching, goes well with not only nature such as green forests but also decent urban places.

MATERIALS

- D-Ring Iron coated with sation
- Buckle Woojin Big-dog Curved lock Acetal LX30
- Webbing 100% Polyester

SIZE

SIZE	Width	Neck
S Small	20mm	22~32mm
M Medium	25mm	31~46mm
L Large	25mm	40~64mm

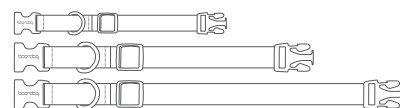

※ The size table above may vary depending on the measurement method and body type.



HOW TO USE

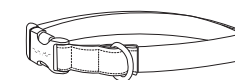
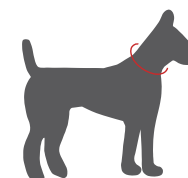

1. Adjust the size to fit the circumference of your dog's neck and put it on using a buckle.
2. The ideal size for dogs is when there is a space for about two fingers to fit in after they wear it.

Original Collar / Color



Red



Yellow



Green



Navy



Black



White



Gray Lemon



Aqua Pink



Khaki Orange



Cream Blue

Collars



Martingale Original Collar / Color



Red



Yellow



Green



Navy



Black



White



Gray Lemon



Aqua Pink



Khaki Orange



Cream Blue

Martingale Original Collar 10 colors / 3 sizes

Boondog Martingale Original Collar is made of soft webbing, away from the semi-choke format made of stimulating steel material. In usual circumstances, there's no tightening around dog's neck, so it can be comfortable.

But when your dog moves forward or pulls with strong force, it is tightened to the neck so that you can control your dog with as little stimulation as possible.

MATERIALS

- D-Ring, Square-Ring Iron coated sation
- Buckle Woojin Big-dog Curved lock Acetal LX30
- Webbing 100% Polyester

SIZE

Size	Width	Neck
XS X-Small	20mm	20~24mm
S Small	25mm	22~28mm
M Medium	25mm	28~38mm
L Large	25mm	36~54mm

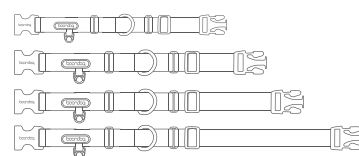

※ When selecting the size of the Martin Gale series, we recommend to choosing 2~3cm smaller than your dog's neck circumference, and smaller sizes if the sizes overlap.
 ※ The size table above may vary depending on the measurement method and body type.

HOW TO USE

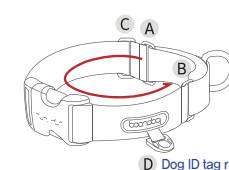
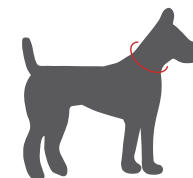

1. Adjust the length of **A** ~ **B** by using **C** (length adjustment clip) so that it fits your dog's neck.
2. It is recommended to use it so that the distance between the square rings in **A** and **B** is about 1~2cm apart depending on the dog's body type and tendency.
3. Please be careful that if you reduce the length of **A** ~ **B** too much, the collar may be excessively tight, and if you adjust it too loosely, it can come off easily.
4. Put an identification tag on **D** and make a pleasant walk!



Relaxed neckline



The neck that tightens when the dog pulls.

Collars



Martingale Wide Collar

10 colors / 2 sizes

Boondog Martingale Wide Collar is made of soft webbing, away from the semi-choke format made of stimulating steel material. Since it is made using a wide webbing of 38mm in width, it is designed to minimize the irritation of the dog's neck by widely distributed force.

And for owners, it helps to control the dog more conveniently. In usual circumstances, there's no tightening around dog's neck, so it can be comfortable. But when your dog moves forward or pulls with strong force, it is tightened to the neck so that you can control your dog with as little stimulation as possible.



MATERIALS

- D-Ring, Square-Ring Iron coated with sation
- Buckle Woojin Big-dog Curved lock Acetal LX30
- Webbing 100% Polyester

HOW TO USE

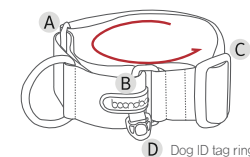
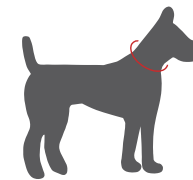

1. Adjust the length of A ~ B by using C (length adjustment clip) so that it fits your dog's neck.
2. It is recommended to use it so that the distance between the square rings in A and B is about 1~2cm apart depending on the dog's body type and tendency.
3. Please be careful that if you reduce the length of A ~ B too much, the collar may be excessively tight, and if you adjust it too loosely, it can come off easily.
4. Put an identification tag on D and make a pleasant walk!

SIZE

	Size	Width	Neck
M	Medium	38mm	24~38mm
L	Large	38mm	35~59mm

※ When selecting the size of the Martin Gale series, we recommend to choosing 2~3cm smaller than your dog's neck circumference, and smaller sizes if the sizes overlap.

※ The size table above may vary depending on the measurement method and body type.

Martingale Wide Collar / Color



Red



Yellow



Green



Navy



Black



White



Gray Lemon



Aqua Pink



Khaki Orange



Crea Blue

Harnesses



0109 Harness 9 colors / 5 sizes

0109 Harness has added some design elements that are more robust and convenient while inheriting the design sensitivity of the former ones in Boondog. The 0109 harness presents a design that can cover various body shapes.

The Simple way of wearing and comfortable fit of the 0109 Harness will help you and your dog relieve the stress caused by harness wearing

SIZE

Size	Width	Chest	Weight	Dog breed
S Small	20mm	32~45cm	2.5~5kg	Pomeranian, Poodle, Maltese, IG, etc.
SM Small-Medium	25mm	40~57cm	5~10kg	Bichon, Terrier, Dachshund, etc.
M Medium	25mm	44~66cm	9~17kg	French Bulldog, Cocker Spaniel, Welsh Corgi, etc.
ML Medium-Large	38mm	57~79cm	16~25kg	Border Collie, Jindo, Standard Poodle, Husky, etc.
L Large	38mm	64~99cm	24~48kg	Retrievers, Malamutes, Dobermans, Shepherd, etc.

※ The size table above may vary depending on the measurement method and body type.



MATERIALS

- D-Ring, Square-Ring Iron coated with sation
- Buckle Woojin Big-dog Curved lock Acetal LX30
- Webbing 100% Polyester

HOW TO USE

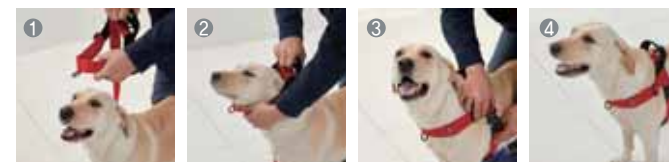

- 1 Hold the harness so that the handle is located on the back
- 2 Find the neck hole which has no-pull D-Ring and slide it over the dog's head.
- 3 Adjust the tightness of the straps to fit around the chest and buckle it.
- 4 How it looks like when you put on a 0109 Harness properly.



Adjust the length adjustment clip in the blue circle to ensure that it is in the most comfortable position. You can prevent armpit chafings as it fits your dog's body type.

0109 Harness / Color



Harnesses



0109 Martingale Harness / Color



Green



Gray Lemon



Aqua Pink



Khaki Orange

0109 Martingale Harness 4 colors / 5 sizes

The 0109 Martingale Harness introduced by Boondog is a harness developed for dog owners who mainly use the “No-Pull function” in existing harnesses from Boondog.

The Boondog 0109 Martingale Harness that developed for a pleasant walk with child through simple, but stylish colour matching, will make enjoyable walking time for dogs and owners with simple wearing way and comfortable fit.

All products of Boondog is Korean brand that not only stylish design, but also custom-made with the highest quality products for each subsidiary materials.

SIZE

Size	Width	Chest	Weight	Dog breed
S Small	20mm	32~45cm	3~5kg	Pomeranian, Poodle, Maltese, IG, etc.
SM Small-Medium	25mm	40~57cm	5~10kg	Bichon, Terrier, Dachshund, etc.
M Medium	25mm	44~66cm	9~17kg	French Bulldog, Cocker Spaniel, Welsh Corgi, etc.
ML Medium-Large	38mm	57~79cm	16~25kg	Border Collie, Jindo, Standard Poodle, Husky, etc.
L Large	38mm	64~99cm	24~50kg	Retrievers, Malamutes, Dobermans, Shepherd, etc.

※ The size table above may vary depending on the measurement method and body type.

HOW TO USE

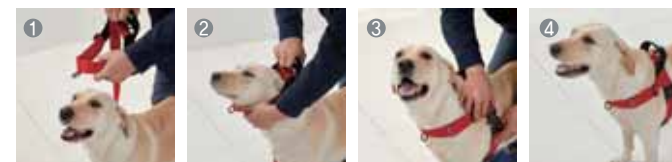

- 1 Hold the harness so that the handle is located on the back
- 2 Find the neck hole which has no-pull D-Ring and slide it over the dog's head.
- 3 Adjust the tightness of the straps to fit around the chest and buckle it.
- 4 How it looks like when you put on a 0109 Harness properly.



Tip
for preventing
armpit chafing



Adjust the length adjustment clip in the blue circle to ensure that it is in the most comfortable position.
You can prevent armpit chafings as it fits your dog's body type.

D-ring for no-pulling



Before Pulling
Relaxed Chestline



Dog Pulls
The Chest that tightens
when the dog pulls.

Harnesses

Jogger Harness

3 colors / 5 sizes

The Jogger Harness is a new designed harness with an engineering angle that covers the entire back and holds the chest with stomach, under the neck.

It does not go through the head or raise the legs, it reduces your dog's excitement and allow you to wear it very quickly and comfortable fit.

Enjoy comfortable and enjoyable walk with a new Jogger Harness that does not hurt dog's neck or armpits.

MATERIALS

- D-Ring A7075 Aluminum
- Buckle Woojin Big-dog Curved lock Acetal LX30
- Webbing 100% Polyester
- BackPlate 100% Nylon, 100% Aerosilver

Jogger Harness Harness / Color



Green



Orange



Cream

HOW TO USE

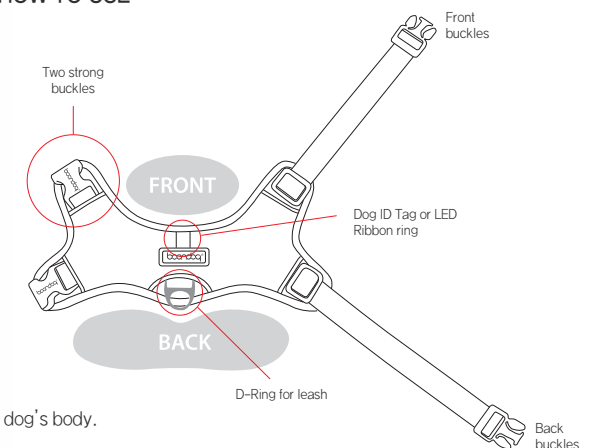

- 1 Adjust the length of the leash part of the harness so that it fits your dog's body.
- 2 Put the packpiece of the harness on your dog's back.
- 3 Fasten the buckle which is attached on the front webbing part that goes on your dog's chest.
- 4 Fasten another buckle which is located right behind the front one.
This part goes around between you dog's belly and chest.

Dogs that don't hate the way they wear it through their heads can wear it faster and more conveniently when they use it with the front buckle fastened in advance.

SIZE

	Size	Width	Chest	Weight
S	Small	20mm	32~45cm	2.5~5kg
SM	Small-Medium	20mm	40~57cm	5~10kg
M	Medium	25mm	44~66cm	9~17kg
ML	Medium-Large	38mm	57~79cm	16~25kg
L	Large	38mm	64~99cm	24~24kg

※ The size table above may vary depending on the measurement method and body type.



Reflector scotch that shines even in dark allows you to take a safe walk at night.

Harnesses

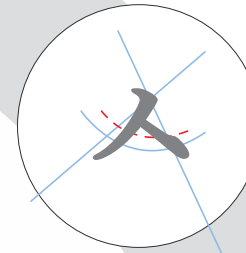

Optimal angle to prevent choking

0109 harness is designed with a diagonal design, the shape of an alphabet "A". This design features an optimal angle to prevent a dog from strangling and armpit chafing, helping your dog to take a pleasant walk.

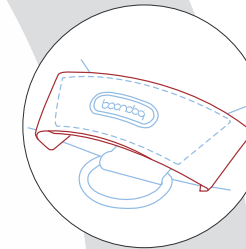

Emergency grip

It can be used conveniently if your dog acts unexpectedly and needs quick control.

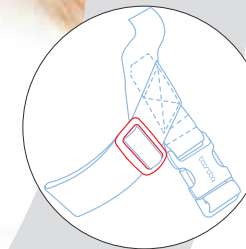

Length adjustable clip that prevents armpit chafings

Adjust the clip so that the lower part of the harness is in a comfortable position for your dog's body shape. This feature provides comfort for dogs with short legs or large chest.

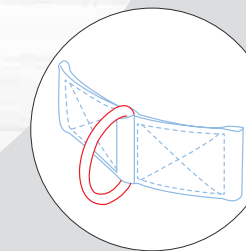

D-ring for attaching dog ID tags and no-pulling

D-ring, located in front of the 0109 harness, can be used for no-pulling purposes, which are easier for owners to control their dog with less force, and is also can be used to hang identification tags.

Leashes



Original Leash

10 colors / 2 sizes

Boondog Original Leash, that goes well with not only natures such as green forests but also decent urban places, used light and soft webbing for a refreshing walk.

The length of 1.4m is a good distance to communicate with your dog while maintaining a comfortable distance.



Original Leash / Color



Red



Yellow



Green



Navy



Black



White

Gray
LemonAqua
PinkKhaki
OrangeCream
Blue

MATERIALS

- D-Ring Iron coated with sation
- Hook Diecasting Zinc
- Webbing 100% Polyester / Handle Aerosilver, Neoprene

SIZE

	Size	Width	Length
S	Small	20mm	140cm
L	Large	25mm	140cm

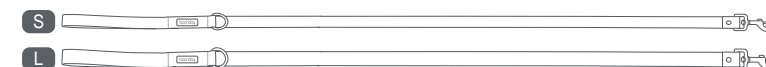

Leashes



Twin Leash / Color

Red &
BlackYellow &
BlackRed &
GreenBlack &
WhiteRed &
Navy

Dual Leash / Color



Yellow



Green

Gray
LemonAqua
PinkKhaki
OrangeCream
Blue

Twin Leash 5 colors / 2 sizes

Twin Leash is for owners who have to walk two dogs at the same time. The stylish two-line color matching makes your dogs stand out more, and the difference in length between the two lines provides comfortable distance for dogs with different walking tendencies.

SIZE	Size	Width	Length	
	S Small	20mm	49cm	54cm
	L Large	25mm	53cm	58cm

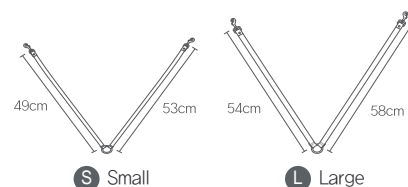

Dual Leash 6 colors / 2 sizes

Dual Leash connects leash and harness to control a strong dog. It is also helpful for walking two dogs at same time!

SIZE	Size	Width	Length	Weight
	S Small	20mm	100~140cm	152g
	L Large	25mm	100~140cm	173g

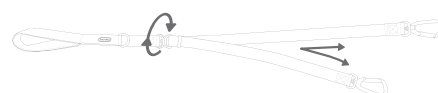

Handsfree Leashes



Play Leash 2.0 9 colors / 2 sizes

Play Leash 2.0 also can be adjusted to fit in various walking situation and can make more convenient walk for both owner and dog.

It features a convenient buckle-type detachable method which enables quick and easy wearing. It is also comfortable and hygienic since the inner part of the handle, where people touch the most, is made by combining Neoprene cushion and aerosilver fabric. Aerosilver is a new composite functional material that exhibits both powerful antibacterial and fast-drying, providing a refreshing fit.

Safety short grip in Play-Leash 2.0 provides you with easy control in an unexpected situation or when you have to keep your dog at a short distance.

SIZE

Size	Width	200 Length
S 스킨	20mm	200cm
L 라지	25mm	200cm



※ The size table above may vary depending on the measurement method and body type.



MATERIALS

- Buckle Woojin Big-dog Curved lock Acetal LX30
- D-Ring Iron coated with sation
- Hook Diecasting Zinc
- Webbing 100% Polyester / Handle Aerosilver, Neoprene



The handle was made using "aerosilver," a healthcare fiber with strong antibacterial properties and fast drying.

HOW TO USE



- Using the buckle on the handle, it is easy to attach and detach on the pillar or waist.
- If you pull the outside part of the leash based on the position of buckle and handle(to the direction of the arrow), you can shorten it, making it convenient to use as a handle.
- If you pull the inside part of the leash(to the direction of the arrow), you can lengthen it, making it useful for shoulder and waist wear.
- You can easily control your dog at an emergency situation or when you have to keep your dog at a short distance, by safety short grip.



Play Leash 2.0 / Color



Handsfree Leashes



Play Leash 250 / 320 / Color



Play Leash 250/320 9 colors / 2 sizes

The length of 2m50cm and 3m20cm Play Leash can be adjusted to fit in various walking situation. It can make it more convenient to walk for both owner and dog.

The length adjuster clip, made of aerial aluminum, will keep your dog safe from the surroundings. Our stylish color provides perfect matching with any color, especially with Boondog's collar and harness.

MATERIALS

- G-Clip Anodizing 6061 Aluminum
- D-Ring Iron coated with sation
- Hook Diecasting Zinc
- Webbing 100% Polyester

SIZE

Size	Width	250 Length	320 Length
S Small	20mm	250cm	320cm
L Large	25mm	250cm	320cm

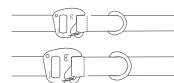

※ The size table above may vary depending on the measurement method and body type.

HOW TO USE

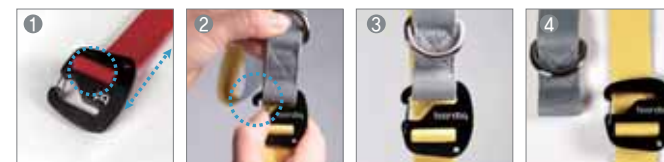

- 1 Adjust the length of leash on the aluminum clip just like adjusting bag straps to a comfortable length.
- 2 You can easily wear and remove Play-Leash by gently pressing the safety clip, which is made to prevent the leash from falling out, and releasing the leash to the direction where the clip is opened.
- 3 Clip and leash before detachment
- 4 Play-Leash removed from clip after detachment



Waterproof



Joy Original Collar / Color



Light Purple



Yellow



Blue

Joy Traffic Leash35 / Color



Light Purple



Yellow



Blue

Joy Original Collar 3 colors / 3 sizes

As a waterproof material, Joy Original Collar does not get wet or dirty when walking in rainy or snowy weather or in a swimming pool and outdoor activities.

SIZE	Size	Width	Length	Weigt
S	Small	20mm	22~32cm	45g
M	Medium	25mm	31~46cm	79g
L	Large	25mm	40~64cm	90g

Joy Traffic Leash 35 3 colors / 2 sizes

As a waterproof material, Joy Traffic Leash is a short leash does not get wet or dirty when walking in rainy or snowy weather or in a swimming pool and outdoor activities.

SIZE	Size	Width	Length	Weigt
S	Small	20mm	35cm	63g
L	Large	25mm	35cm	74g



MATERIALS

- G-Clip Anodizing 6061 Aluminum
- D-Ring, O-Ring Iron coated with sation
- Carabiner Anodizing 7075 Aluminum
- Webbing Poly, PVC Coat
- Buckle Woojin Big-dog Curved lock Acetal LX30

Joy Leash 2.0 / Color



Light Purple



Yellow



Blue

Joy Leash 2.0 3 colors / 2 sizes

As a waterproof material, Joy Leash is the hands-free leash does not get wet or dirty when walking in rainy or snowy weather or in a swimming pool and outdoor activities.

SIZE	Size	Width	Length	Weigt
S	Small	20mm	200cm	147g
L	Large	25mm	200cm	195g

Outdoors



Outdoor Mat 2 colors / 2 sizes

3M
THINSULATE™
Insulation

Let's go out with the lightweight and portable Boondog Outdoor Mat! For outdoors used, yes, it is Waterproof!

As a fabric for sportswear, it can be fully waterproof in anywhere.

Not only prevent wet floors, but also prevent cold or moisture from floors, and it is very convenient to clean by placing it on a pet stroller or bed, so that does not penetrate even if dog makes a mistake or spills a snack.

MATERIALS

- Shell Nylon water-repellent
- Inner 3M Thinsulate

SIZE

	Size	unroll	Packing Size	Weigt
S	Small	90 x 60cm	14 x 22cm	350g
L	Large	110 x 85cm	15 x 30cm	580g

※ The size table above may vary depending on the measurement method and body type.

Outdoor Mat / Color



Maple Orange



Forest Green

Aurora Bag 2 colors

The Aurora Sling Bag adds style-oriented convenience to the design sensitivity of Boondog.

The Aurora Sling Bag features stylish design and completeness with stylish color patterns in black and white and the aurora reflector logo.

Aurora sling bag includes a variety of storage types, from the front pocket with plenty of storage space to the back pocket for important items. Also it is equipped with D-ring and poop bag dispenser inside the rear zipper.

Not only are all our products have stylish designs, but for safety, we used all the subsidiary materials by choosing the finest ones. Most of all, we made it with all our hearts and soul.

Aurora Bag / Color



Ivory



Black

Boonball Soft

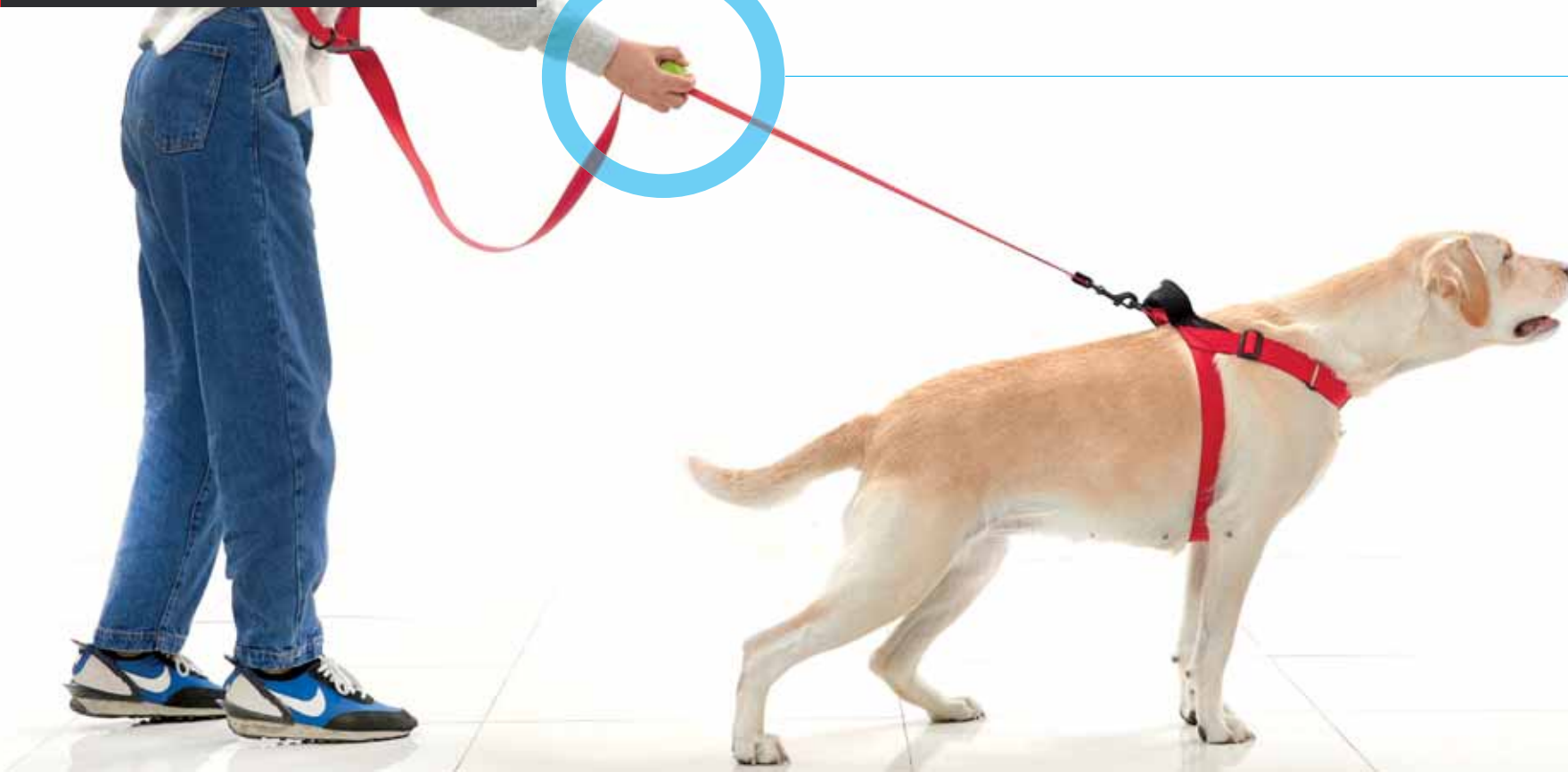

without **BOONBALL**

There are many unexpected situations when you go out walking with your dog. Have you ever been dragged or got chafed hands when they immediately runs away from you?



with **BOONBALL**

This small 'Boonball' protects both you and your dog from various dangerous situations. Comfortable, soft grip that fits into your hand makes your walk more enjoyable.



Boonball Soft 5 colors

Boonball is a dog leash 'grip' developed for safe and convenient dog walking.

It is for owners who can't handle or control the power of their dog while taking a walk and for dogs who love playing with balls.

Boonball is made out of eco-friendly materials so that it is safe for your dogs to bite and play with.

The design and color of the Boonball started with the idea that it has to be a stylish accessory on any dog leash it is attached. Boonball is a product that has been tested dozens of times, ranging from over 100 product sketches to product raw materials, colors, and functionality.

Boonball is registered with the Korean Intellectual Property Office.

Patent number [10-2137466]

SPECIFICATION

- Diameter : 5.5cm
- Weight : 80g
- Outside Material : Eco Elastomer Silicone
- Inside Material : PC_ABS

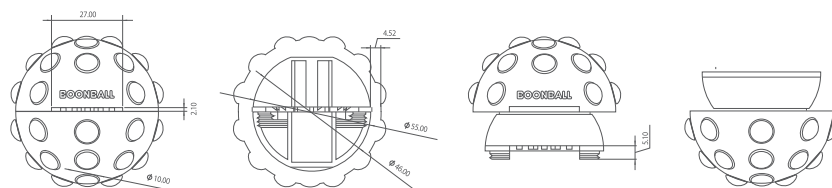

HOW TO USE



- 1 Rotate the ball counterclockwise and separate it up and down. Then, put the leash on the bump of the Boonball.
- 2 Rotate the the upside of the ball clockwise and secure it firmly on the leash.
- 3 Turn it all the way to the end and tighten it. If the mouth of the Boonball is twisted and didn't tightened horizontally, it may not be fixed properly.
- 4 When you want to move the position of the Boonball, you can move it easily and quickly by slightly opening it counterclockwise, moving it to the desired position, and fixing it again.



You can put the Boonball in a best position to hold with your hands, depending on the walking situation and the dog's tendency.



Boonball Soft / Color



Red



Yellow



Yellow Green



Black



Light Purple

G Bag / G pouch



Silicone Water Bowl



G Bag / G Pouch 5 colors

G-Bag and G-Pouch are dog poop bag dispenser developed for a pleasurable walking with your dog. The G-Clip, which is fixed at the bottom, is a poop bag carrier that allows you to walk with one hand free when there is no garbage bin around.

HOW TO USE



- 1 Hang the one-touch buckle located top of the G-Bag/G-Pouch on the D-Ring.
- 2 Secure the G-Bag/G-Pouch to the leash using the fixing velcro on the back.
- 3 G-Bag has dispenser function at the bottom which can take out a poop bag one by one, and there is also space for light personal items such as treats or car key.
- 4 G-Pouch is a compact size model that can only fit a poop bag, and you can take it out from the side.

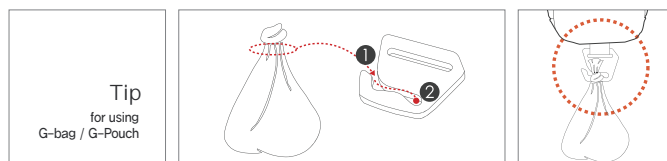

Tip
for using
G-bag / G-Pouch

After tying the poop bag, put the knot from the inlet hole ① of the G-Clip to the end of the fixing hole ② to fix the poop bag without falling out.

G Bag / G Pouch / Color



Silicone Water Bowl 5 colors

A Must Have Item, called Water Bowl!

Boondog's silicone Water Bowl is a foldable that has a generous capacity of 750ml, it can be conveniently used for walking, camping, or mountain climbing. Yes, it is easy to carry in anywhere.

Only 100g lightweight bowl can be conveniently carried in anywhere with a sturdy premium Carabiner.



SIZE

Diameter	Depth	Weight
18.8cm	6.5cm	100g

※ The size table above may vary depending on the measurement method and body type.

Silicone Water Bowl / Color

