

EC Motor

The newest motor of EC series motors are designed with advanced electronic control technology. Comparing with traditional shaded pole motor, EC motor displays an obvious advantage in energy saving, saving up to 70%, it can greatly reduce the electricity cost for motor operation and carbon dioxide emissions. Not only that, due to the heating of ECM series motors themselves are very low, it would lead to works more efficient and make motor running more stable and reliable.

The input power of shaded pole motor YJ5812 is 15W, input power of EC42 is 3W, assuming the motor operating 12 hours per day and 365 days a year, and the price of electricity is EUR0.20 KWh. Each EC42 can save electricity about 52.3KWH, and save charge EUR10.51 per year. After 5 years, total save EUR62.56.

See below curve about charge compare:

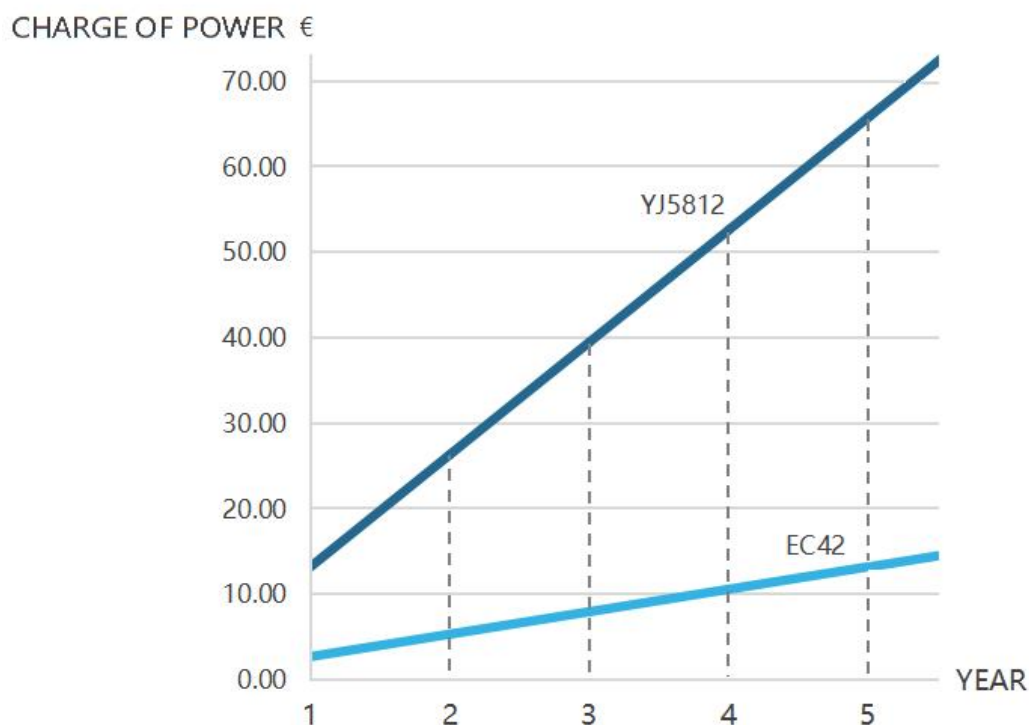

At present, EC motor can use in following ventilation device:

- ❖ Ventilation fan for 4" 5" 6"
- ❖ In-Line Fan, Duct fan, Pipe fan, duct size from 100 - 300 mm
- ❖ Cooker hoods
- ❖ Developing EC motor according to your products and demand is available.

EC42

Supply Voltage: 100-240V AC;

Structure: 1 phase / 3 phase;

Bearing : Sleeve bearing or Ball bearing;

Speed design:

- ❖ Certain speed for certain loading;
- ❖ Constant speed for similar loading;
- ❖ Control speed by PWM or Vsp or others;

Loading Power: Max 11w;

Protection style: Over current;

Protection level: IP00/IP55

Shaft design: Diameter is 4 or 5 mm, others will be follow customer's request;

Installation: 2*M4 threading hole, center distance is 28mm;

Apply to CE, ROHS, REACH.

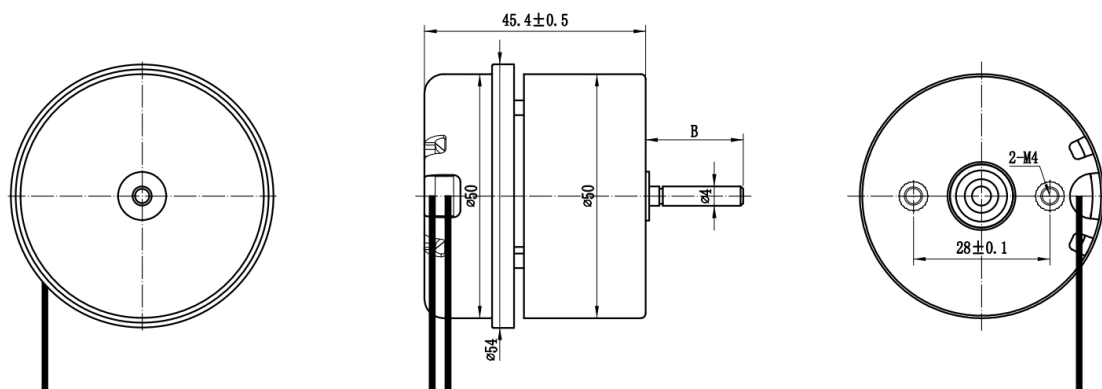

Feature

The speed is controlled by electronic control technology, so that the motor is more efficient and energy-saving and more environmentally friendly when it reaches a higher speed. When exchanging air indoors, fresh air can enter the room more quickly.

Compared to the exhaust fan, like 8", 10", 12" etc., even more size, using capacitor motor, its price is only slightly higher than that of capacitor motor, and because it is less affected by the price fluctuation of metal materials, its price is relatively stable.

Application



EC52

Supply Voltage: 100-240V AC;

Structure: 3 phase;

Bearing : Ball bearing;

Loading power: Max 50w;

Protection style: Over current;

Protection level: IP54

Speed design:

- ❖ Certain speed for certain loading;
- ❖ Constant speed for similar loading;
- ❖ Control speed by PWM or Vsp or others;

Shaft design: Diameter is 8 - 12 mm, others will be follow customer's request;

Installation: 4*M4 threading hole, average distributed on a circle with a diameter of 58mm;

Apply to CE, ROHS, REACH.

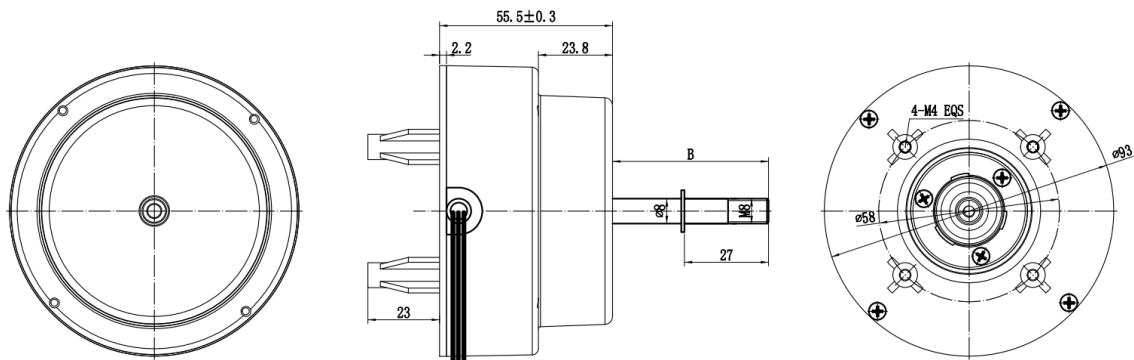

Feature

The motor adopts a fully enclosed design. Whether it is used in a duct fan or a range hood, it can effectively isolate the control panel from erosion and damage by moisture, oil gas and other substances, which is beneficial to extend the service life of the motor.

Compared to traditional hoods motor, like shaded pole motor, capacitor motor, its price is only slightly higher than that of capacitor motor, and because it is less affected by the price fluctuation of metal materials, its price is relatively stable.

Application

