

HIGH PRESSURE DOSING PUMPS

for the chemical and pharmaceutical industry

- Pump drive controllable via web interface
- Flow rates from 0.1 to 500 ml/min
- Back pressure up to 380 bar
- Temperature range (pump head inside) 0°C to 80°C
- Pumped medium temperature -20°C to 100°C
- 4 different pump head sizes
- Various plug & play temperature and pressure sensors
- Heated pump heads with temperature control
- Heat sinks for all pump heads
- FDA and USP Class VI compliant materials, including batch traceability
- Pump drive and heads can be converted at any time
- Calibrate by yourself flow, - temperature - and pressure sensors



Pump drive

- Web-based control possible via any network-enabled device
- External control via inputs and outputs on the rear of the device
- Standard with 40 bar or 400 bar pressure sensor in PEEK or stainless steel
- Up to two temperature sensors in PEEK or stainless steel
- All spare parts available down to the smallest screw
- Retrofittable at any time
- Solid and robust construction made of anodized aluminum, 1.4404 and 1.4305 stainless steel
- Mounting options for external accessories on both side panels
- LAN and WLAN compatible
- Temperature control for heated pump heads
- FDA and USP Class VI materials used, including batch traceability
- Plug & Play temperature and pressure sensors
- Calibrate by yourself the flow rate in up to 5 possible memory locations
- Calibrate by yourself flow, - temperature - and pressure sensors



Pump head

- Choice of 4 different pump heads
 - 25ml PEEK or stainless steel (max. 200 bar, in special cases up to 380bar)
 - 100ml PEEK or stainless steel (max. 200 bar, in special cases up to 380bar)
 - 250ml stainless steel (max. 100 bar, in special cases up to 200bar)
 - 500ml stainless steel (max. 50 bar, in special cases up to 80bar)
- Integrated mixer or heating surface
- Heating function for tempering the pump head including temperature control
- Heat sinks for all pump heads
- Various flow paths available depending on the application
- Quick opening of the pump head for replacing the high-pressure seals
- Data chip for pump head identification and data recording
- FDA and USP Class VI materials used, including batch traceability
- Sealing materials for chemical and pharmaceutical applications
- Temperature range (pump head inside) 0°C to 80°C
- Pumped medium temperature -20°C to 100°C



Special components & consumables



- All standard components can be made from other materials upon request
- Custom components or modifications to existing components are also available

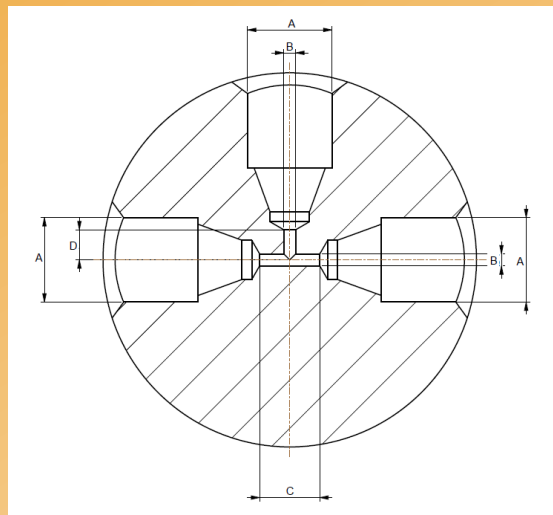
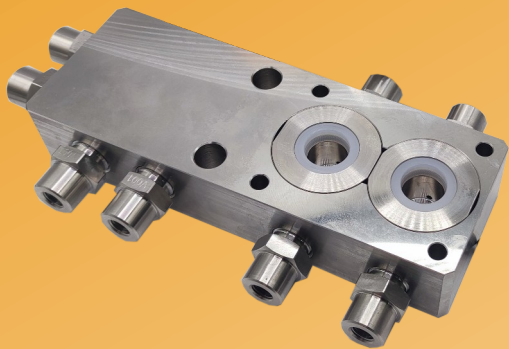

- 1/16" Capillaries in PEEK or Stainless Steel
- 1/8" Capillaries in PEEK or Stainless Steel
- 1/8" to 1/8" Connectors in PEEK or Stainless Steel
- 1/16" to 1/16" Connectors in PEEK or Stainless Steel
- 1/8" to 1/16" Connectors in PEEK or Stainless Steel
- 1/8" and 1/16" T-Connectors in PEEK or Stainless Steel
- 1/8" to 1/16" Reducers with 0.5mm and 1.0mm ID
- 1/16" and 1/8" Blanking Plugs
- 1/16" and 1/8" Ferrules in PEEK or Stainless Steel
- Pump Seals for Chemical and Pharmaceutical Applications
- Pistons
- Check Valves
- Disc Seals



Flow paths

up to 100ml/min

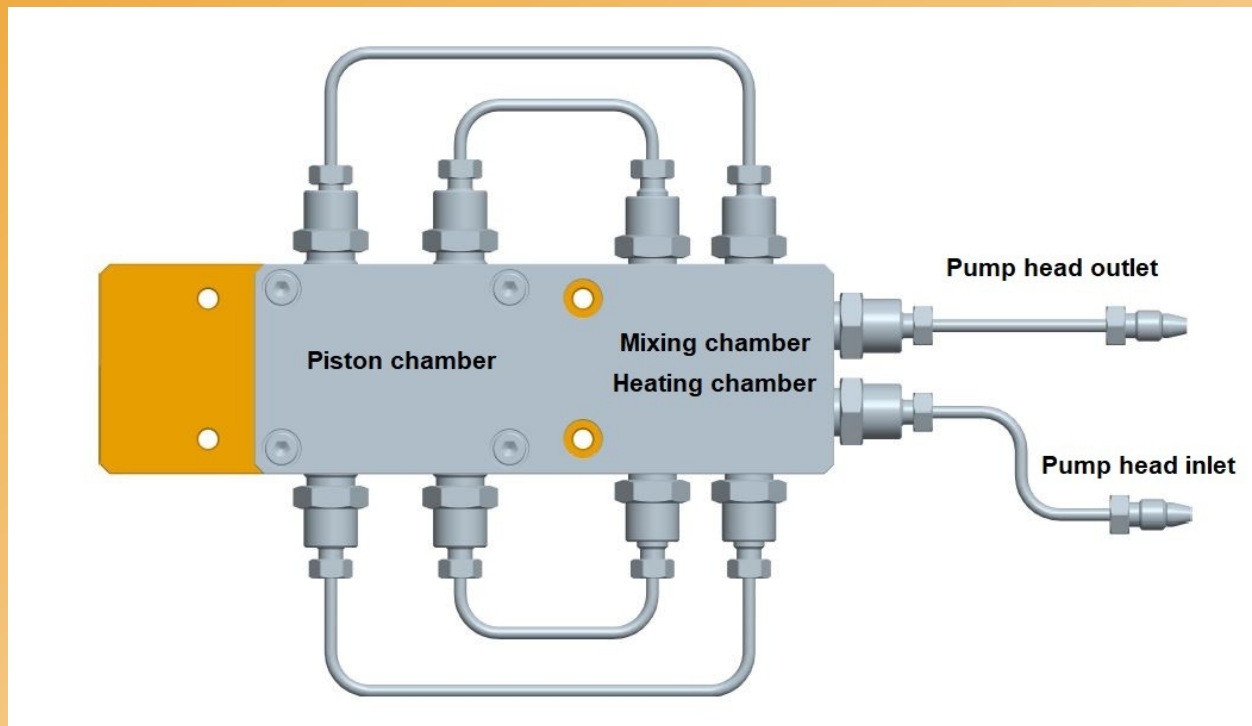

Flow paths

from 100ml/min

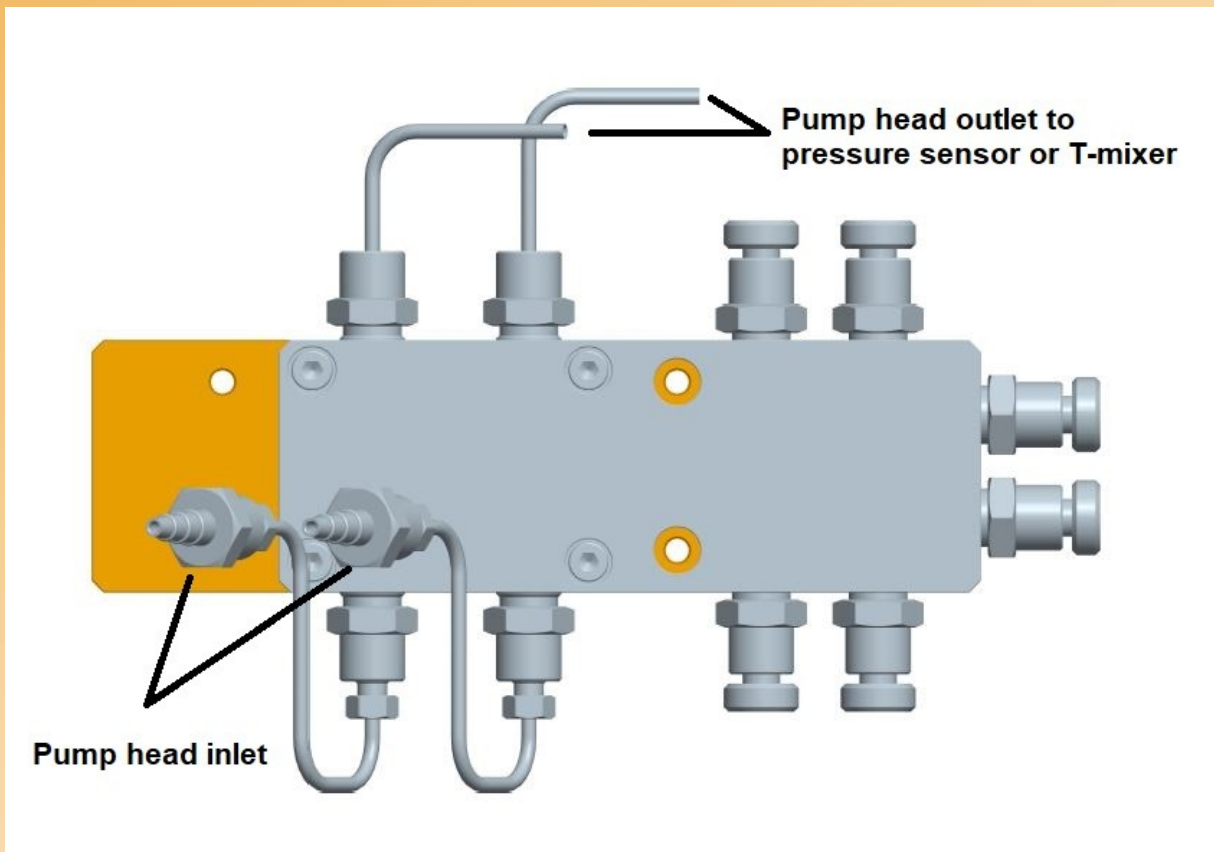
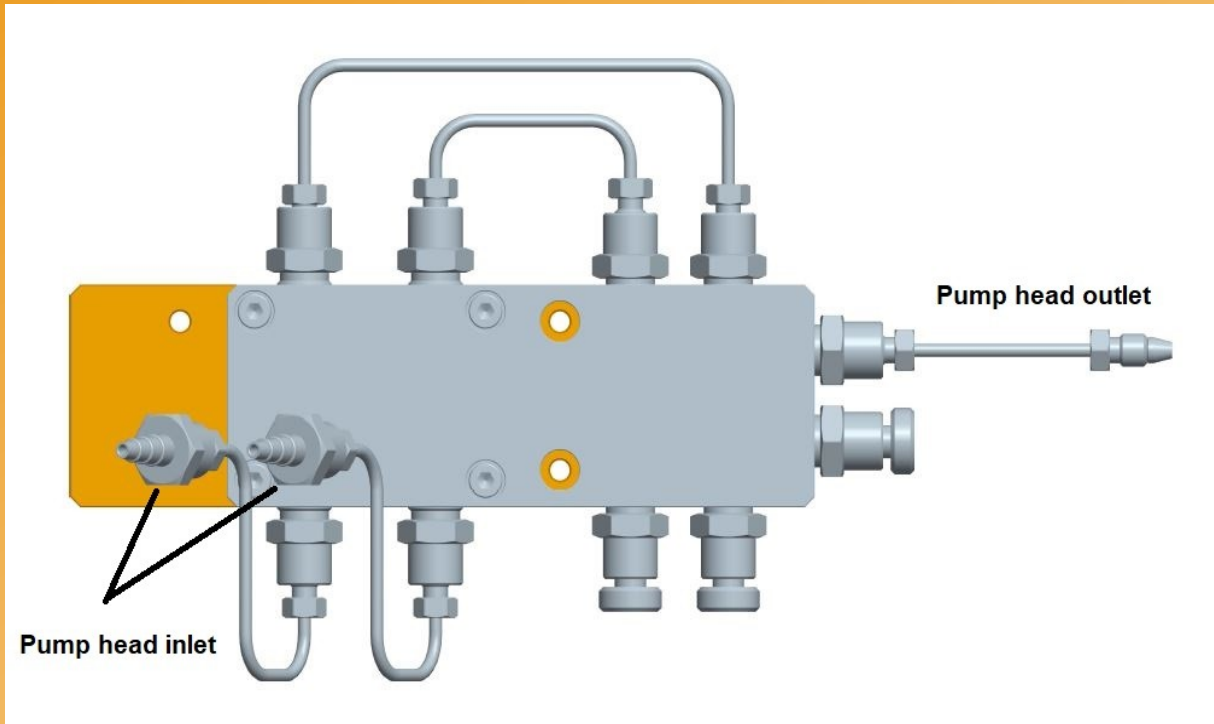

Flow paths

for internal mixing of two pumps

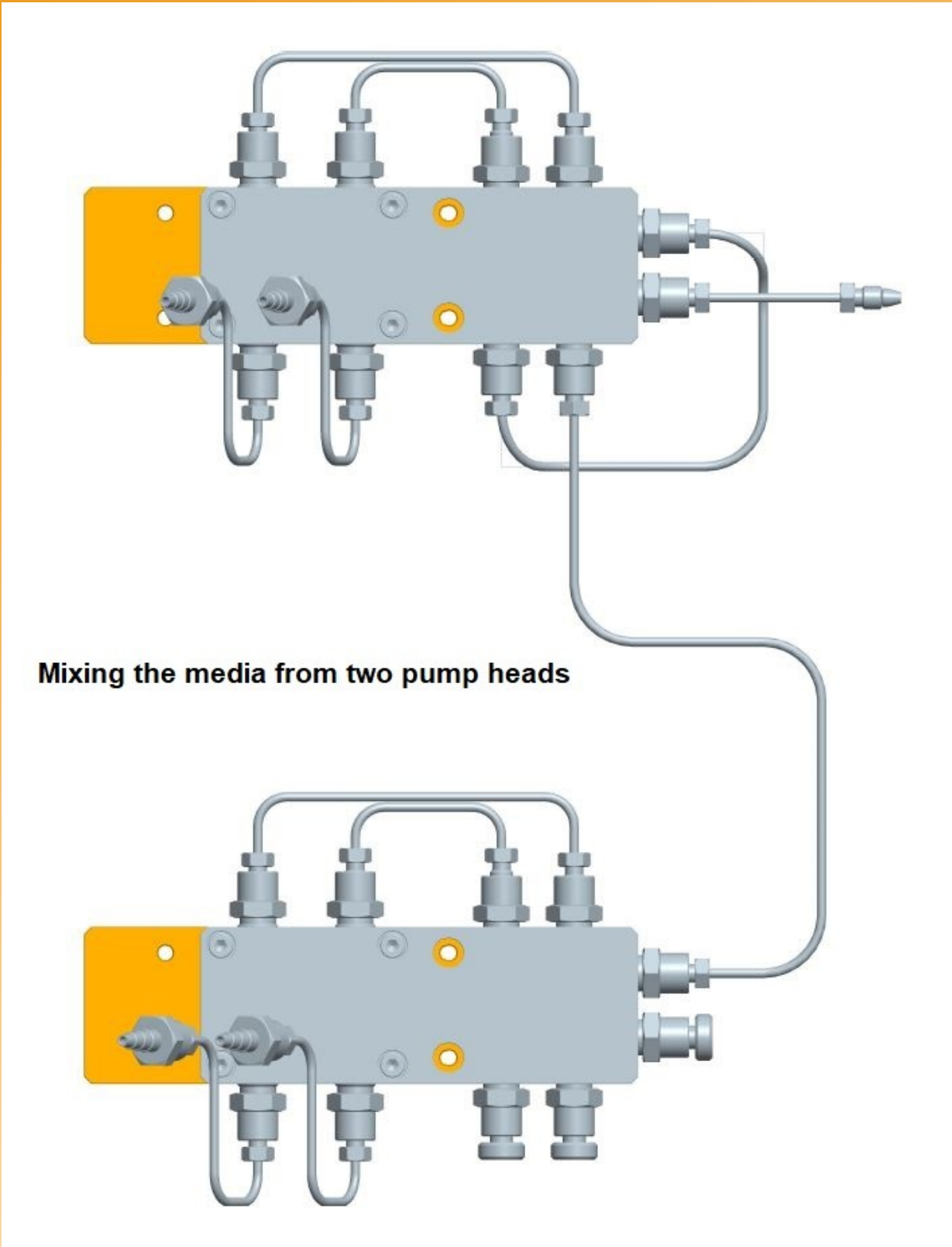

Thoughtful solutions

for the chemical and pharmaceutical industry

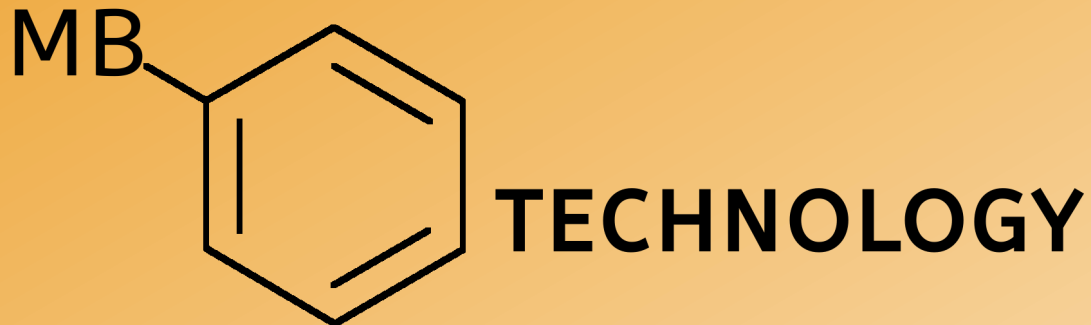

Your specialist for

pump technology and special parts manufacturing